

Wastewater Application for Sewer Permit
CALL FOR INSPECTION 928-204-7111
24 Hour Notification is Required



City Of Sedona Public Works Department
 108 Roadrunner Drive Sedona, AZ 86336
 (928) 204-7111 • Fax: (928) 282-5348

Check <u>all</u> that apply:	<input type="checkbox"/> New Connection	<input type="checkbox"/> Repair
------------------------------	---	---------------------------------

Applicant Information		Phone:		WW Permit#:	
Job Site Address:		Cell Phone:		Date Rec'd:	
E-mail:		Parcel #:		Permit Fee	
Backflow Device Required?	Yes No	Cap Fee Paid \$		Date Cap Fee Paid	

OWNER NAME:		CONTRACTOR NAME:	
Phone:		Company:	
Address:		Address:	
Cell Phone:		Phone:	
E-Mail:		Cell Phone:	
		E-mail:	
		City Business License #:	
		ROC State License #:	

Remarks:

Residential Properties	For Residential Connections a detailed site plan must be submitted.	Commercial Properties	For Commercial a site plan with dimensions and/or units must be submitted.
No of Units		WW Rate Category	
Connection Location		Type of Business	
Upstream		Units of Usage	
Manhole No		No of Units	
		Connection Location	

I hereby swear, or affirm, under penalty of perjury that I have read and examined this application for a Wastewater Permit, and know the same to be true and correct. All provisions of Laws and ordinances governing this type of work, will be complied with, whether specified herein or not. The granting of a permit does not presume to give authority, to violate, or cancel the provisions of any other state, or local law regulating construction or the performance of construction.

Print Name	Signature	Date
------------	-----------	------

WASTEWATER PERMIT APPLICATION CHECKLIST



Public Works Department
108 Roadrunner Drive Sedona, AZ 86336
(928) 204-7111

- Complete Application (Make sure application is completely filled out)**
Take the time to double check the property address, parcel number, owner and contractors Names and correct address/phone information. Make sure that all information is completely filled in, spelled correctly and that the application is **signed** by the applicant.
- For residential sewer connections:** A detailed site plan must be submitted before a permit can be issued. *
- For commercial sewer connections:** A plot plan with dimensions and/or units must be submitted before permit can be issued. *
- Inform applicant of the new Chapter 13 Requirements:** Backwater Prevention Device (give examples if requested)
- Capacity Fee: Dry lines only:** Capacity fee does not have to be paid at this time (please note on the gold card that capacity fee has not yet been paid to alert the inspector in the field of this issue).*
- All other permit applications:** Capacity fee must be paid before permit can be issued. *
- Please make sure that it is noted on the “Dry Line” permit that the capacity fee has not been paid.*
- Remarks:** Please make sure that the applicant fills in the remark section with any issues that need to be addressed or issues that the inspectors will need to address in the field (this can also be used by Community Development Counter for any issues).
- Signature owner/contractor:** Please insure that the applicant signs the application after reading and filling the application completely. Also make sure that the City Representative also signs and dates the application as well. *
- Every attempt shall be made to do no work, or store no materials within City Rights-of-Way:** (i.e. portable toilets, dumpsters, construction materials or equipment, stockpiles, etc.). In the event that this is not possible, a Right-of-Way permit shall be secured **prior** to working within, or placing anything within, the Right-of-Way.
(Give application if requested)
- This completed form is to be attached to the application packet**

Note: If items followed by an asterisk (*) are not submitted with the initial application, the review process cannot begin. The customer will have to provide the missing items before the w.w permit process can begin. Without these items it could prolong the permit process for issuance.

- Customer informed of missing submittal information. By: _____

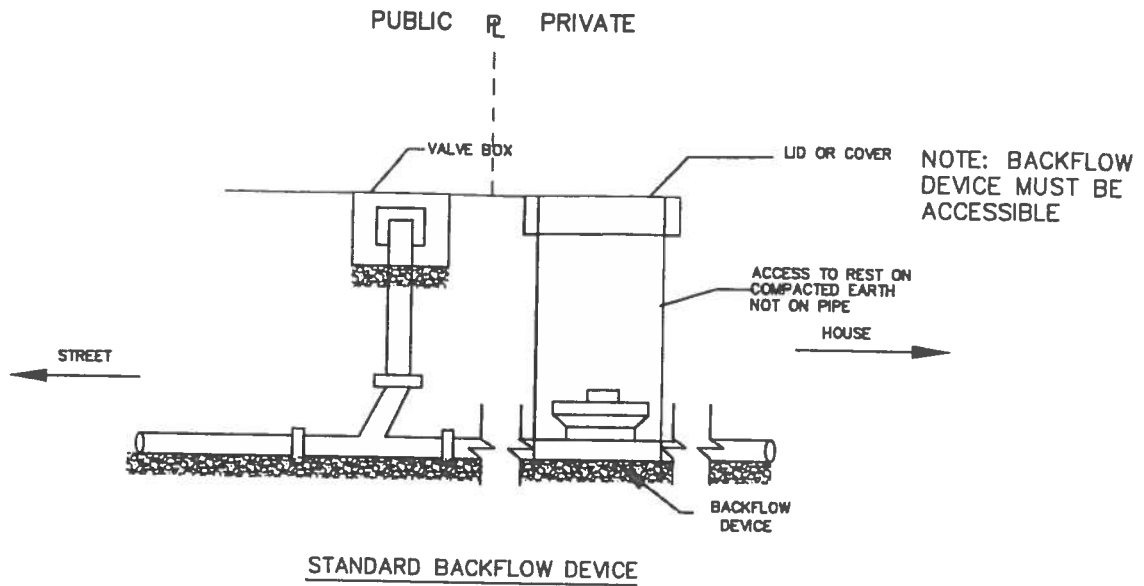

STANDARD BACKFLOW DEVICE

BACKFLOW DEVICE NOT REQUIRED
UPSTREAM MANHOLE LOWER THAN
LOWEST DRAIN FIXTURE

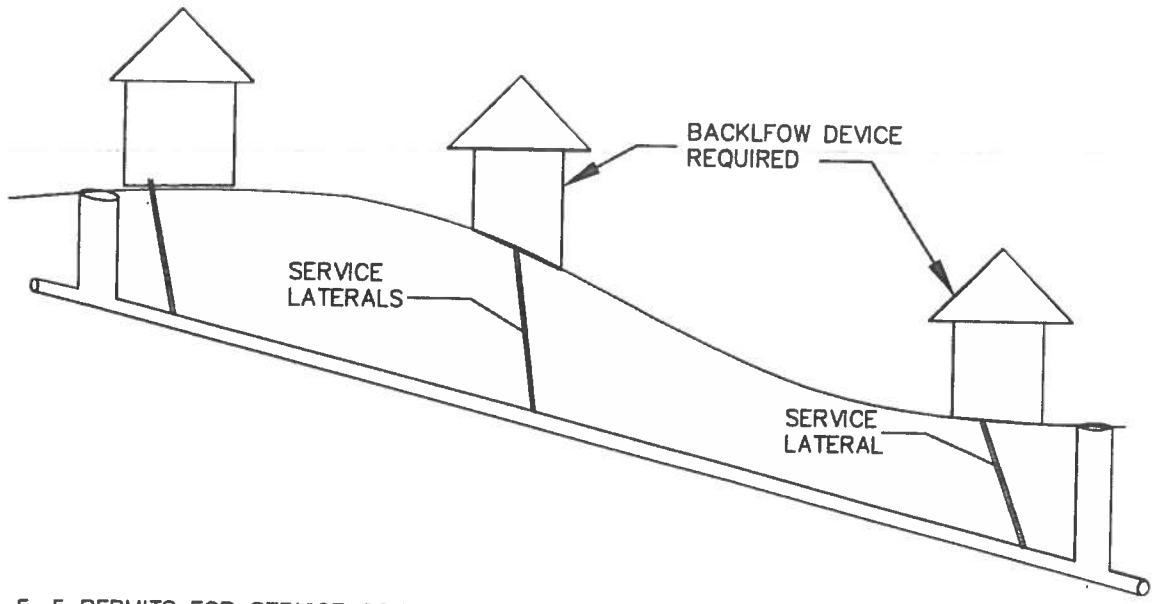

§ 13-5-5 PERMITS FOR SERVICE CONNECTIONS.

B. When the lowest drain fixture for a facility served by a gravity sewer lateral is less than 4 inches higher than the nearest upstream manhole, a backwater prevention device shall be installed on the lateral on private property exterior to and down stream of the facility served by the lateral. A backwater device shall be installed on existing laterals by December 31, 2011 or when the lateral is replaced or repaired, which ever occurs first.

	STANDARD DETAIL.	BACKFLOW DEVICE DETAIL	CITY ENGINEER _____ DATE _____
--	------------------	---------------------------	--------------------------------

Example

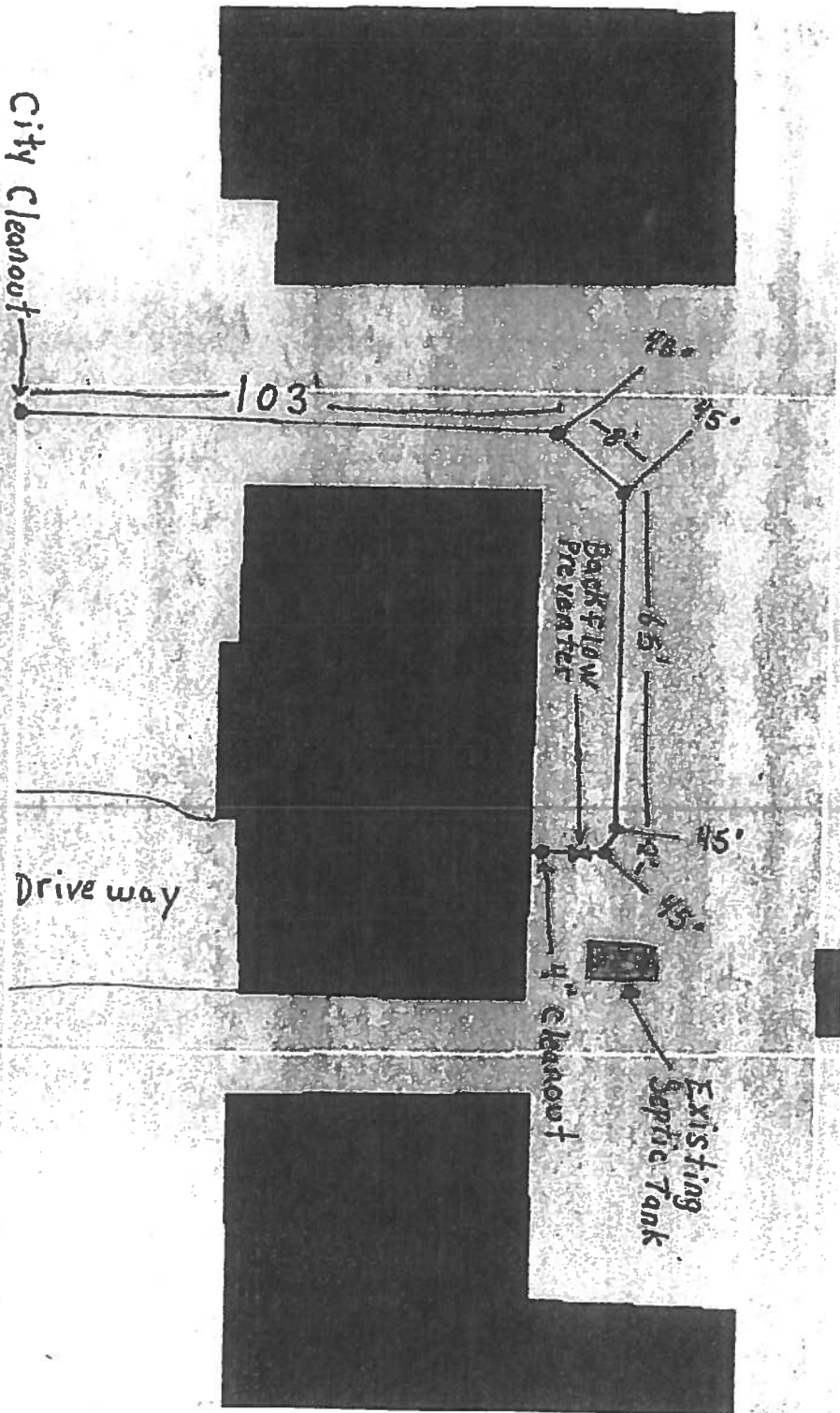

(NOTE) Size and type of pipe: 4" SDR 35 P.V.C.