

INDEX OF DRAWINGS:

- 1. ALTA SURVEY
- 2. SITE PLAN
- 3. LANDSCAPE PLAN

RESTAURANT/ LOBBY BUILDING

- 4. FLOOR PLAN (MAIN LEVEL)
- 5. FLOOR PLAN (BASEMENT & UPPER LEVEL)
- 6. CONCEPTUAL ELEVATIONS

GUEST ROOM BUILDINGS

- 7. WEST WING FLOOR PLAN
- 8. EAST WING FLOOR PLAN
- 9. GYM/SPA/SERVICE BASEMENT
- 10. CONCEPTUAL ELEVATION

RETAIL BUILDING

- 11. RETAIL FLOOR PLAN
- 12. DWELLING UNITS AT UPPER LEVEL
- 13. CONCEPTUAL ELEVATION

COLOR KEY:

- Hotel Element: 120 Units - (1, 2 and 3 Story)
- Restaurant / Bar
- Lobby / Admin.
- Retail Element

--- Lodging Use Area = Approx. 3.9 Acres

PROJECT DATA:

Site Area = Approx. 5.92 Acres

Building/ Description	Units	Unit Area (s.f.)	Total Area (s.f.)	Parking required
Northeast Building				
Hotel Lobby-Admin-(1st floor)		6,350 s.f.	N/A	0 sp.
Restaurant - Bar-(1st floor)		5,500 s.f.	1 space / 100 s.f.	55 sp.
Restaurant - Bar-(Ext. Terrace)				0 sp.
Hotel Meeting Space- (Bsmnt.)		6,500 s.f.	N/A	0 sp.
Hotel Support Space- (Bsmnt.)		4,000 s.f.	N/A	0 sp.
Dwelling units -(2nd floor)	5	560	2,800 s.f.	2 space / unit
Total		25,150 s.f.		10 sp.
Northwest Building				
Retail - (ground floor)		6,500 s.f.	1 Space/250 s.f.	26 sp.
Dwelling units -(2nd floor)	6	6,500	2 space / unit;	12 sp.
			1.5 spaces after	
			5 units	
Total		13,000 s.f.		38 sp.
Southwest Building				
Hotel Guest Rooms - King & 2 Queen				68 Units plus
1 story	4	3,716 s.f.		10 employees
Stairs/Stor./Circulation		4,727 s.f.		
Service Basement (est.)		6,286 s.f.		
2 story	12			
3 story	60			
Total	76	16,728 s.f.		76 sp.
Southeast Building				
Hotel Guest Rooms - King & 2 Queen				44 Units plus
1 story	8	3,716 s.f.		54 sp.
Stairs/Stor./Circulation		6,640 s.f.		
3 story	36	27,549 s.f.		
Total	44	37,905 s.f.		54 sp.
Total Bldg Area:		107,512 s.f.		Parking Required 233 sp.
Total Lodging Units:	120			Parking Provided 220 sp.
				6% over

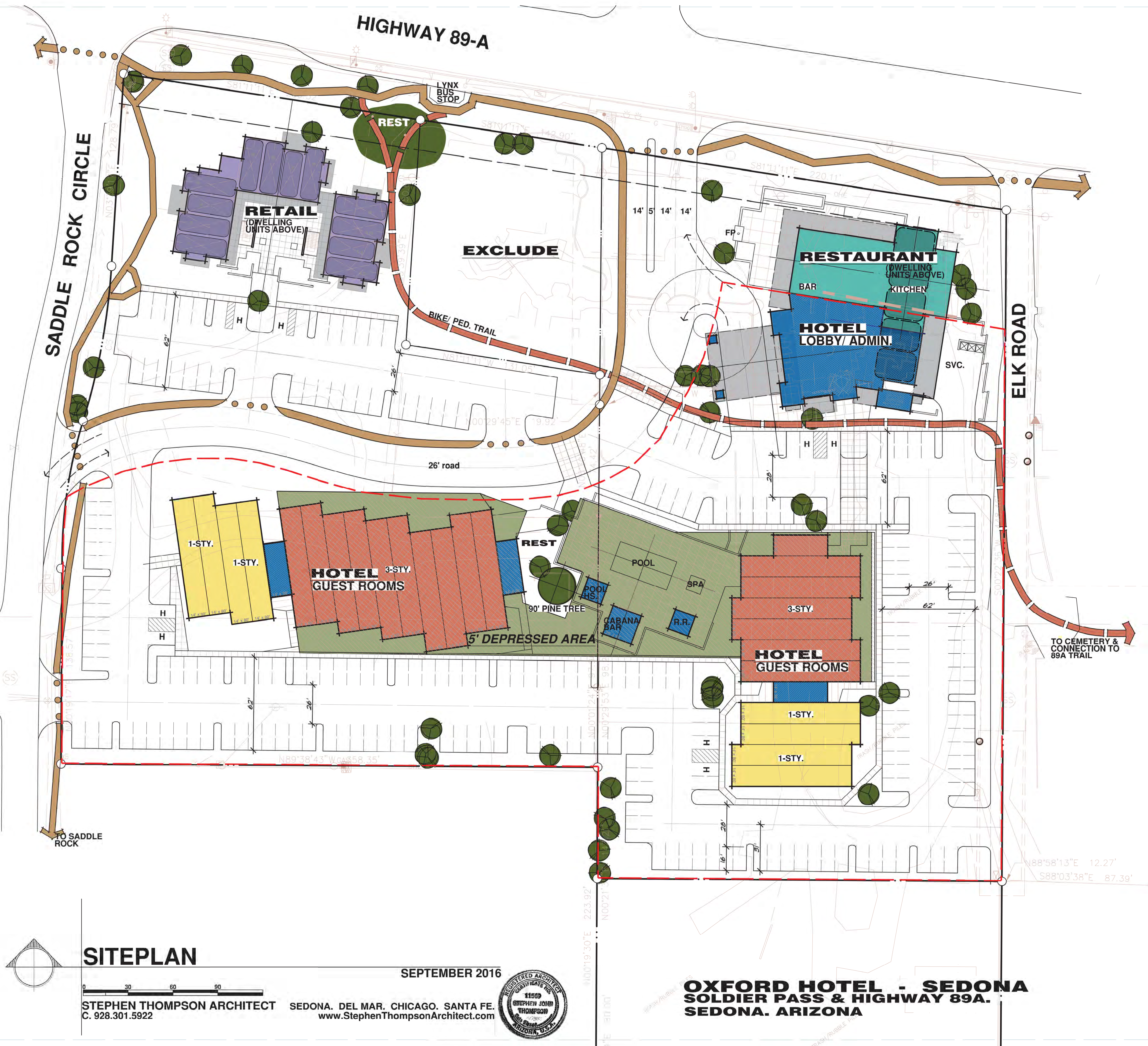

SITEPLAN

SEPTEMBER 2016

STEPHEN THOMPSON ARCHITECT SEDONA. DEL MAR. CHICAGO. SANTA FE.
C. 928.301.5922 www.StephenThompsonArchitect.com



OXFORD HOTEL - SEDONA
SOLDIER PASS & HIGHWAY 89A.
SEDONA. ARIZONA