

RESOLUTION NO. 2017-06

**A RESOLUTION OF THE MAYOR AND COUNCIL OF THE CITY OF SEDONA,
ARIZONA, DESIGNATING A PORTION OF SHADOW ROCK, RIM SHADOWS, AND
CANYON SHADOWS SUBDIVISIONS AS A RESIDENTIAL PERMIT PARKING
AREA.**

WHEREAS, Cities and towns may, pursuant to A.R.S. § 28-627.A.1, regulate the standing or parking of vehicles on streets or highways under their jurisdiction as a reasonable exercise of their police powers; and

WHEREAS, City staff has investigated the issue of creating an area of Residential Permit Parking in the Rim Shadows neighborhood, after having received requests from owners and residents in the Rim Shadows neighborhood, and staff is recommending that the area outlined in Exhibit A be designated an area of Residential Permit Parking; and

WHEREAS, the city engineer has determined that parking in the area is significantly impacted by motor vehicles owned by nonresidents; and

WHEREAS, the Sedona City Code, § 10.20.030.A, requires that parking restrictions become effective only upon specific approval by resolution of the City Council, and where appropriate signs and other markings are installed.

NOW, THEREFORE, BE IT RESOLVED BY THE MAYOR AND COUNCIL OF THE CITY OF SEDONA, ARIZONA that the entire public area in the Rim Shadows and Canyon Shadows Subdivisions, and a portion of the public area in the Shadow Rock Subdivision as described in Exhibit A, is hereby designated an area of Residential Permit Parking, and the City Engineer is authorized to install the necessary postings and highway markings.

PASSED AND ADOPTED by the Mayor and Council of the City of Sedona, Arizona, this 14th day of February, 2017.

Sandra J. Moriarty, Mayor

ATTEST:

Susan L. Irvine, CMC, City Clerk

APPROVED AS TO FORM:



Robert L. Pickels, Jr., City Attorney

Exhibit A

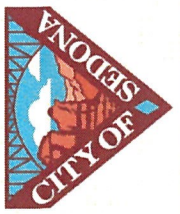
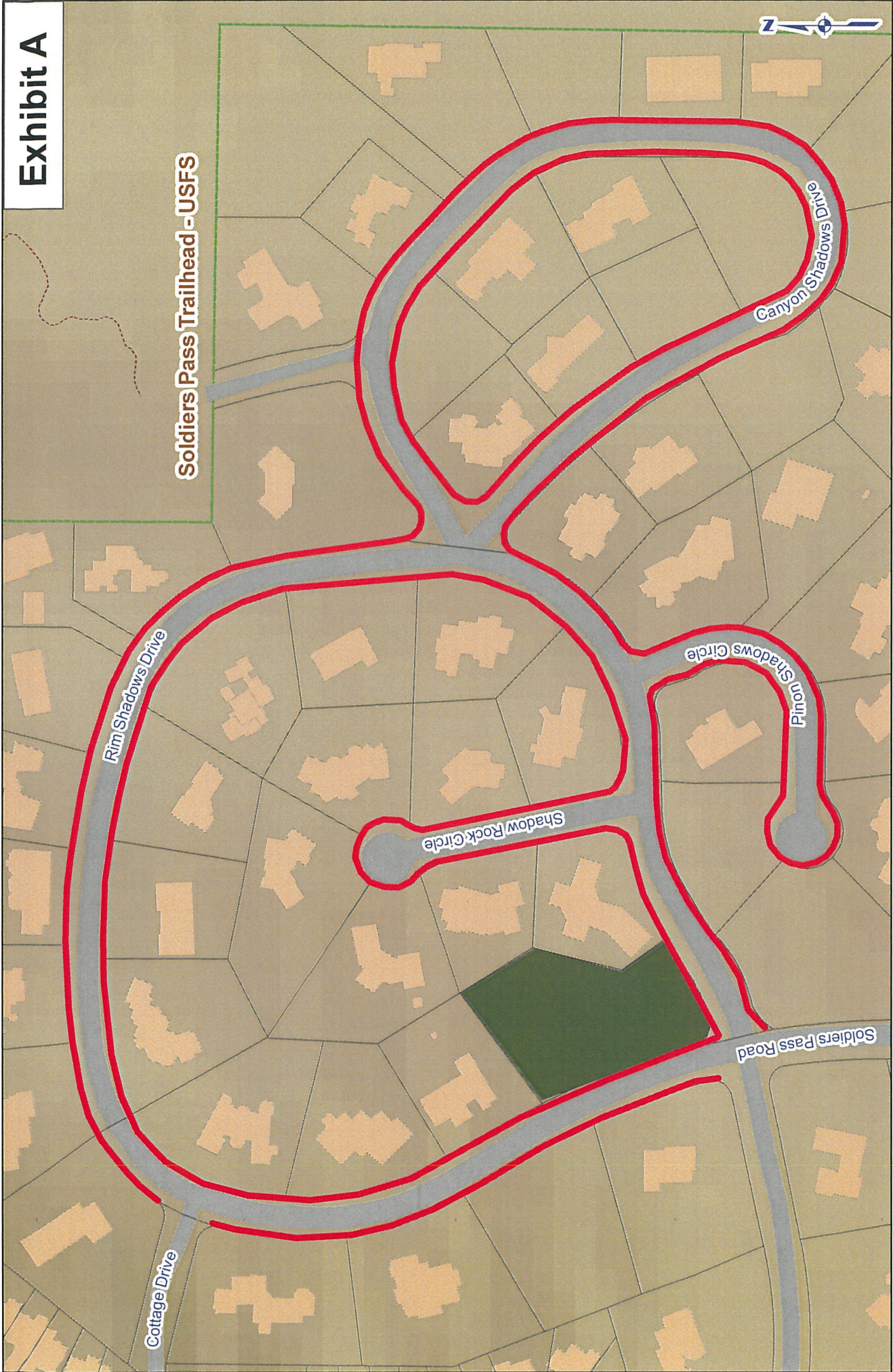
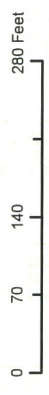

No Parking Zone

— Proposed "No Parking Zones"



This map was designed to provide information about Sedona and has been prepared for general informational purposes only. It is not intended to be used as a legal document or to establish any standards. Every effort has been made to make this map as complete and as accurate as possible. However, no warranty or liability is implied.