

# RD OLSON DEVELOPMENT

## SEDONA, ARIZONA

R.D. OLSON  
DEVELOPMENT  
WATG  
Brightview  
Sefton Engineering  
Eric Brandt Architect  
Richard Hubbell & Associates  
Hammes Surveying LCC  
Kimley-Horn and Associates, Inc.

### SHEET INDEX

- C-1 CIVIL COVER
- C-2 CIVIL PLAN - WEST CLUSTER
- C-3 CENTRAL CLUSTER - CIVIL PLAN
- C-4 NORTH CLUSTER - CIVIL PLAN
- C-5 SOUTH CLUSTER - CIVIL PLAN

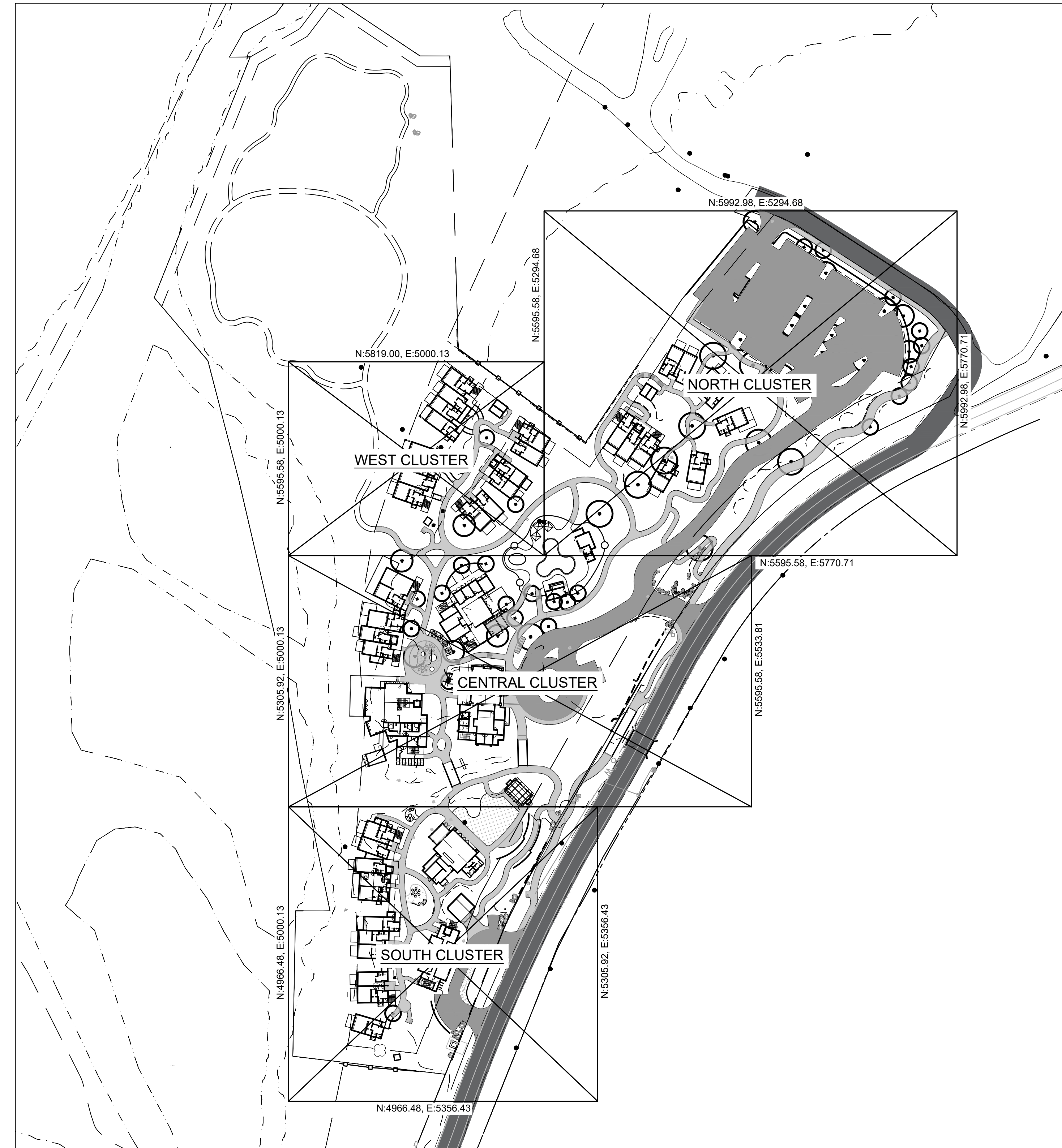

### VOLUMES

EARTHWORKS: (PROPOSED LESS EXIST)  
CUT: 4935 CY  
FILL: 4552 CY  
NET: 4935 - 4552 = 383 CY (CUT)

NOTE: VOLUMES ARE APPROXIMATE

### PROJECT LOCATION

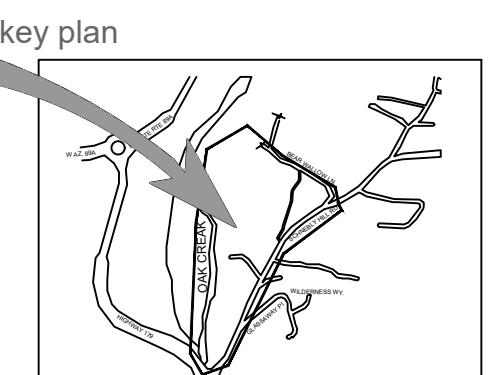

no.	date	issue
2	8/31/2023	CDS SUBMITTAL 2
1	6/1/2023	CDS SUBMITTAL 1

Oak Creek  
Heritage Lodge

COMPREHENSIVE DESIGN SUBMITTA  
MARCH 28TH, 2023

### CIVIL COVER

project no. 201108  
checked by: LS  
drawn by: SS  
component

sheet no.  
page - 1 OF 5

# C-1

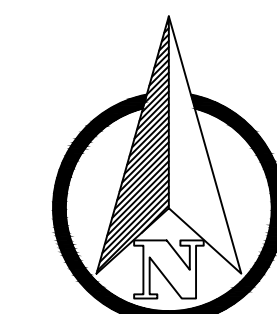

0 40' 80' 160'  
HORIZONTAL SCALE IN FEET  
1" = 80'





MATCH LINE FOR CENTRAL CLUSTER (N:5595.58, E:5770.71)

MATCH LINE FOR NORTH CLUSTER (N:5595.58, E:5294.68)

THIS AREA

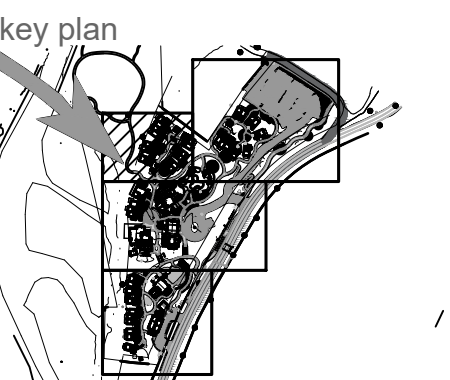

2	8/31/2023	CDS SUBMITTAL 2
1	6/1/2023	CDS SUBMITTAL 1
no.	date	issue

Oak Creek  
Heritage Lodge

COMPREHENSIVE DESIGN SUBMITTAL  
MARCH 28TH, 2023

WEST CLUSTER - CIVIL PLAN

project no. 201108  
checked by: LS  
drawn by: SS

component

sheet no.  
page - 1 OF 5

C-2

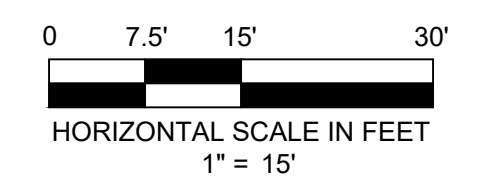
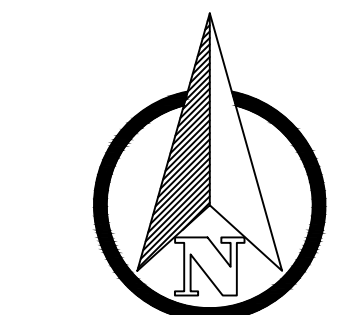

MATCH LINE FOR WEST CLUSTER (N:5595.58, E:5770.71)

MATCH LINE FOR NORTH CLUSTER (N:5595.58, E:5770.71)

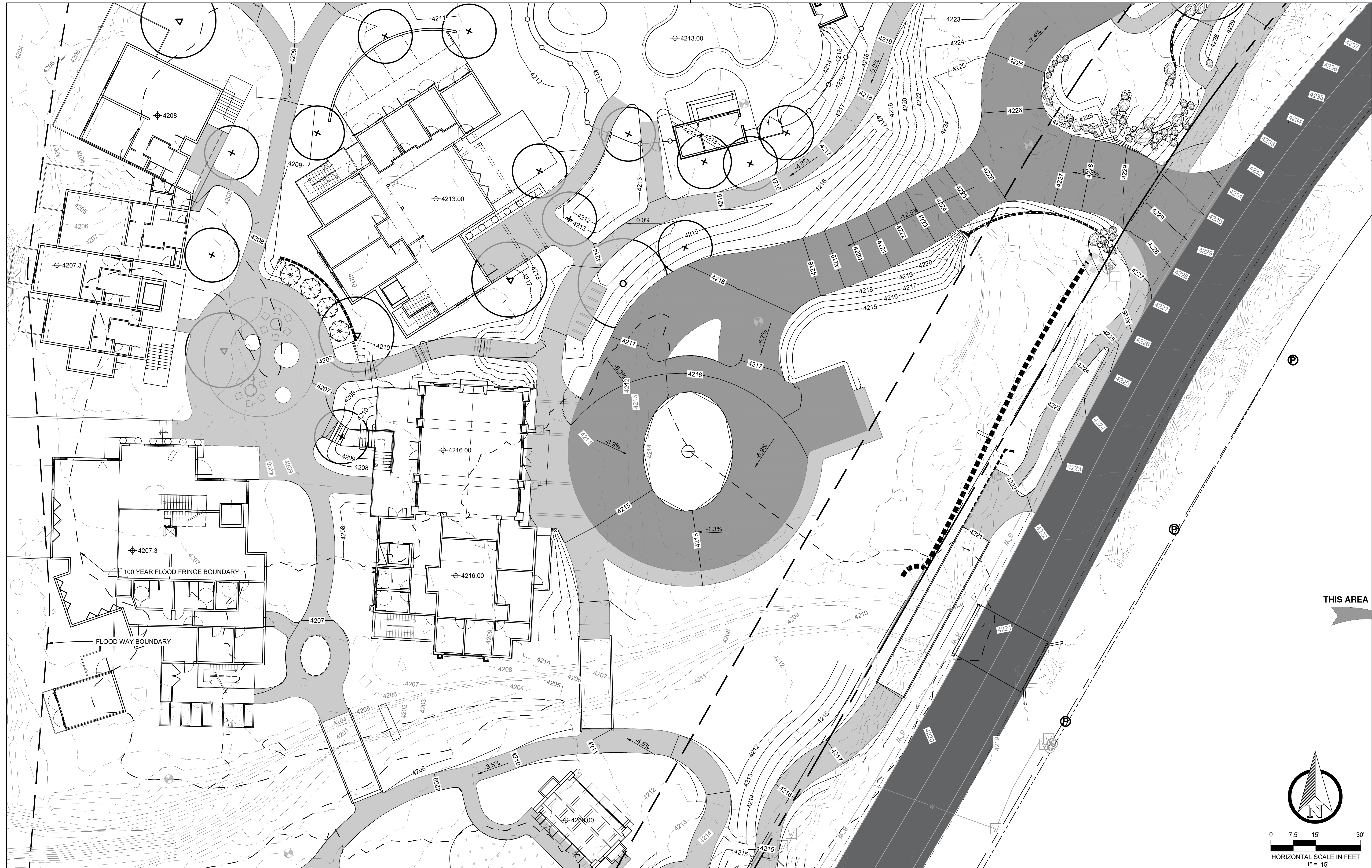

MATCH LINE FOR SOUTH CLUSTER (N:5305.92, E:5533.81)

R.D. OLSON  
DEVELOPMENT

WATG

Brightview

Sefton Engineering

Eric Brandt Architect

Richard Hubbell & Associates

Hammes Surveying LCC

Kimley-Horn and Associates, Inc.

THIS AREA

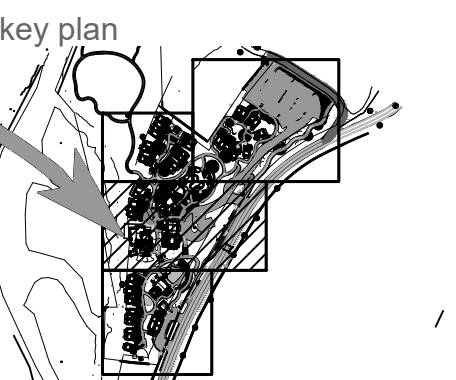

2	8/31/2023	CDS SUBMITTAL 2
1	6/1/2023	CDS SUBMITTAL 1
no.	date	issue

Oak Creek  
Heritage Lodge

COMPREHENSIVE DESIGN SUBMITTA  
MARCH 28TH, 2023

CENTRAL CLUSTER - CIVIL PL

project no. 201108  
checked by: LS  
drawn by: SS

component

sheet no.  
page - 1 OF 5

C-3

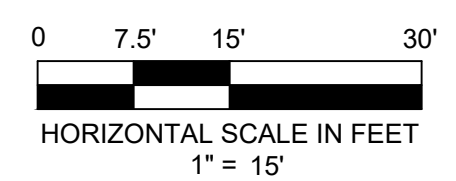
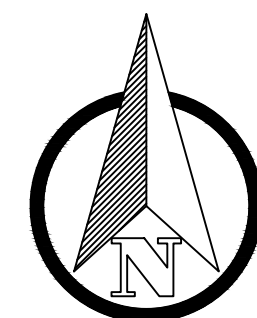



THIS AREA

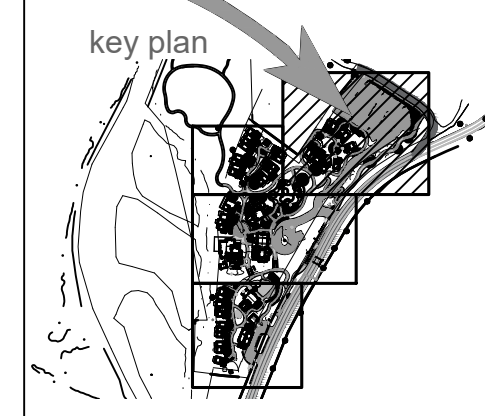

2	8/31/2023	CDS SUBMITTAL 2
1	6/1/2023	CDS SUBMITTAL 1
no.	date	issue

Oak Creek  
Heritage Lodge

COMPREHENSIVE DESIGN SUBMITTAL  
MARCH 28TH, 2023

NORTH CLUSTER - CIVIL PLAN

project no. 201108  
checked by: LS  
drawn by: SS

component

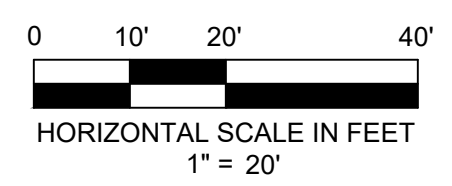
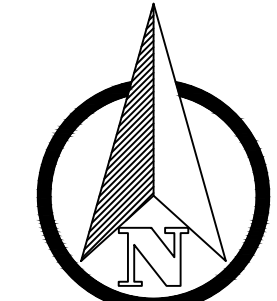

MATCH LINE FOR CENTRAL CLUSTER (N:5305.92, E:5533.81)



THIS AREA

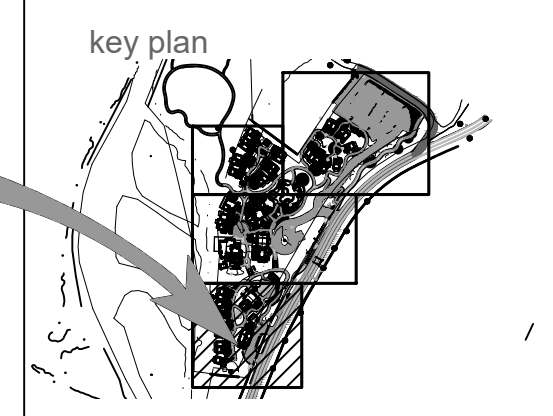

2	8/31/2023	CDS SUBMITTAL 2
1	6/1/2023	CDS SUBMITTAL 1
no.	date	issue

### Oak Creek Heritage Lodge

COMPREHENSIVE DESIGN SUBMITTAL  
MARCH 28TH, 2023

### SOUTH CLUSTER - CIVIL PLAN

project no. 201108  
 checked by: LS  
 drawn by: SS

component

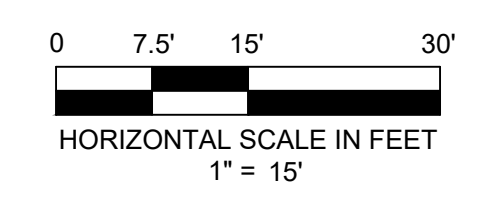
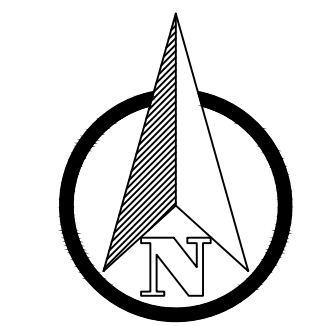

sheet no.  
page - 1 OF 5

# C-5

component