



# The Sirens of Oak Creek

By Robert Louis DeMayo



A hidden, sacred canyon. Eight women. Twelve centuries. And a mystical song that connects it all.

Deep in the wilderness lies a hidden canyon, one that calls out to travelers with its haunting siren song. Sacred wisdom, terrible secrets, and a veil of mystery shroud it – but the power of nature cannot be ignored. Seen through the eyes of eight women across time, Sedona's Oak Creek Canyon calls through the ages, echoing across twelve centuries to capture the minds of visitors from ancient hunter-gatherers to Spanish conquistadors to modern-day seekers of truth. Though these women bear witness to nature's magic their sacred guardianship is matched only by the ill-fated curiosity of the men who seek to plunder the canyon's secrets. As time crashes on, one wave after another, cultures are linked and stories remain unbroken as this lost, ageless canyon brings myths to life and fuels the folklore of generations.



From award-winning, best-selling author, Robert DeMayo, *The Sirens of Oak Creek* is a gripping novel that artfully intertwines local myth with historical fact, carrying timeless themes that reflect the power of nature, magic, and immaterial realms.

★★★★★ "I recommend this book to anyone who likes history, strong female figures, adventure mixed with a little magic."

★★★★★ "An enjoyable mix of local history, legends, and imagination."

★★★★★ "DeMayo's methodically smooth style effortlessly takes the reader on this long journey where everything changes but the landscape. He holds his story confidently and as such you trust him as narrator to play compass amidst centuries of travel, culture and identity that inevitably arrives full circle."



THE SIRENS OF OAK CREEK

ROBERT LOUIS DEMAYO

# THE SIRENS OF OAK CREEK

*Unlock the Secrets and Legends of Sedona's Oak Creek Canyon*



*From Award-Winning, Best-Selling Author*

ROBERT LOUIS DEMAYO



# Timeline

## **Prologue** – *Before*

2,000 B.C. – September

## **Book One** – *The Ancients*

Act I – 800 A.D. – October

Act II – 1395 – November

Act III – 1521 – December

## **Book Two** – *The Spaniards*

Act I – 1705 – January

Act II – 1705 – February

Act III – 1705 – March

## **Book Three** – *The Pioneers*

Act I – 1876 – April

Act II – 1880 – May

Act III – 1885 – June

## **Book Four** – *The New Agers*

Act I – 1987 – July

Act II – 1987 – August

Act III – 1987 – September

## **Epilogue** – *Modern Sedona*

Epilogue – 2019 – October





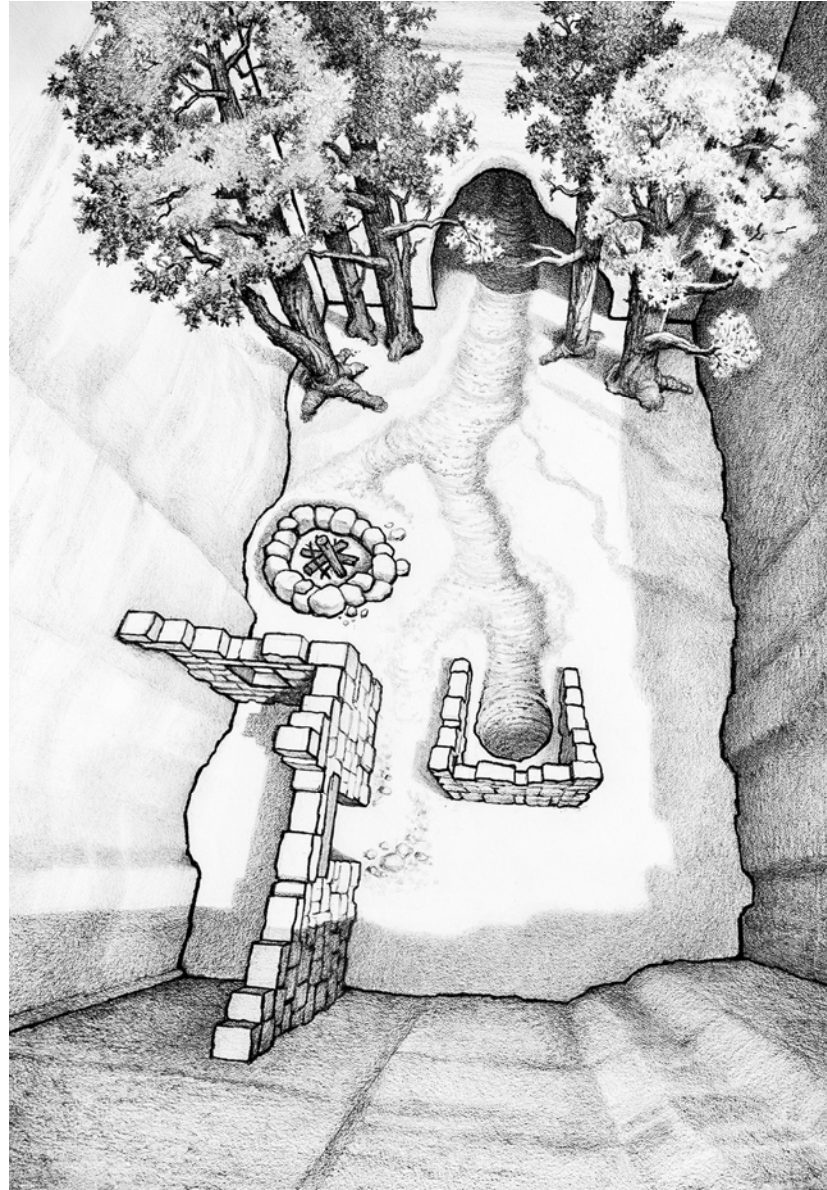



ANDREW HOLMAN  
PHOTOGRAPHY



# THE SIRENS OF OAK CREEK

*Unlock the Secrets and Legends of  
Sedona's Oak Creek Canyon*



*From Award-Winning, Best-Selling Author*

**ROBERT LOUIS DEMAYO**



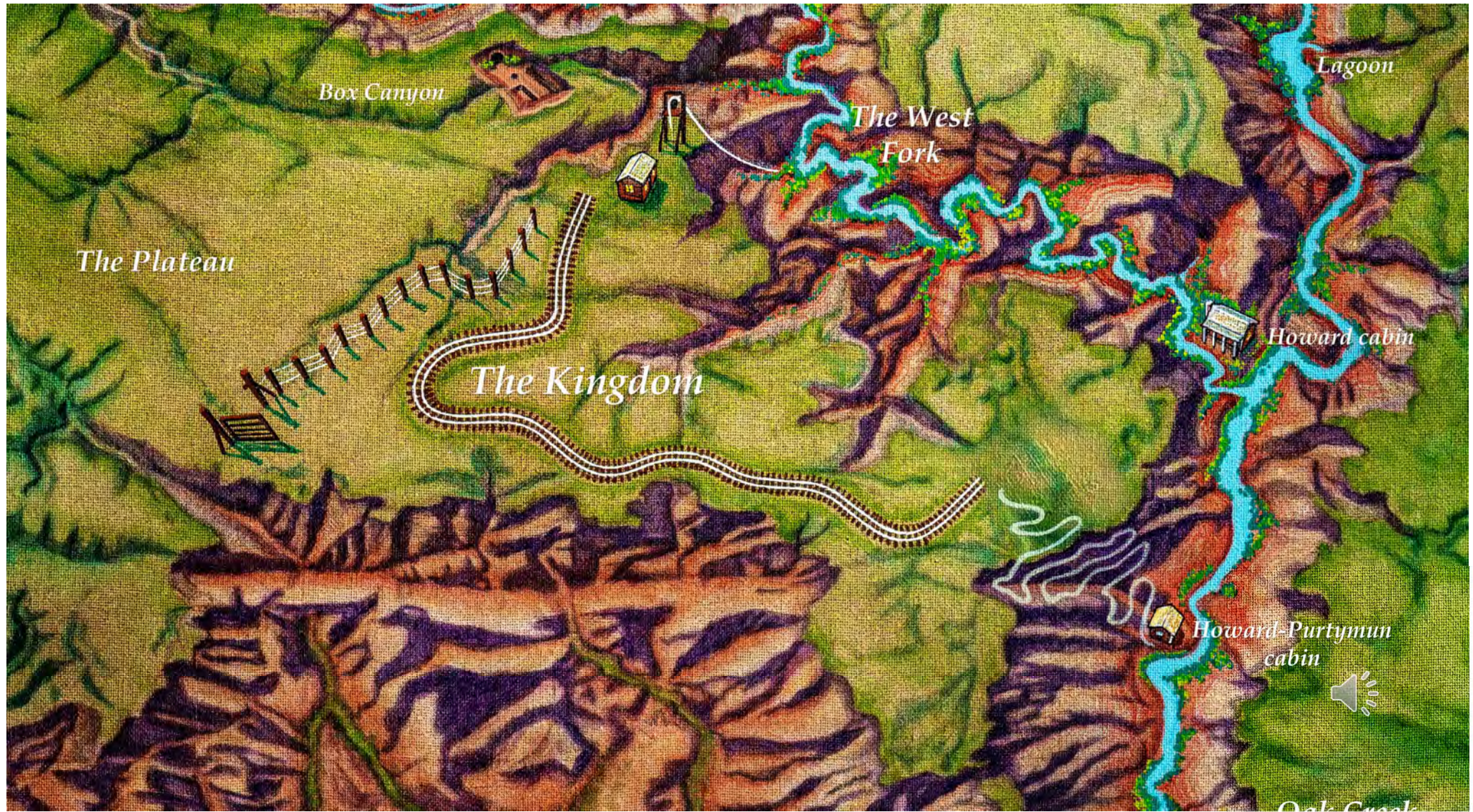









ANDREW HOLMAN  
PHOTOGRAPHY

---

# **AB 3009 – McKinstry Decarbonization Roadmap**

## **November 14, 2023**



# Sustainability Program Foundational Documents

---

## Sedona Climate Action Plan

- ❑ Created in July of 2021
- ❑ Highlighted Goals and Objectives:
  - Reduce Community-wide Emissions 50% by 2030
  - Improve Community Resilience
  - Enhance Community Mobility
  - Increase Renewable Energy Sources
  - Increase Waste Diversion

## Municipal Sustainability Plan

- ❑ Created in 2020
- ❑ Highlighted Goals and Objectives:
  - Be Resilient
  - Be Carbon Neutral
  - Be a Healthy Workplace
  - Be Zero Waste
  - Be Water Smart

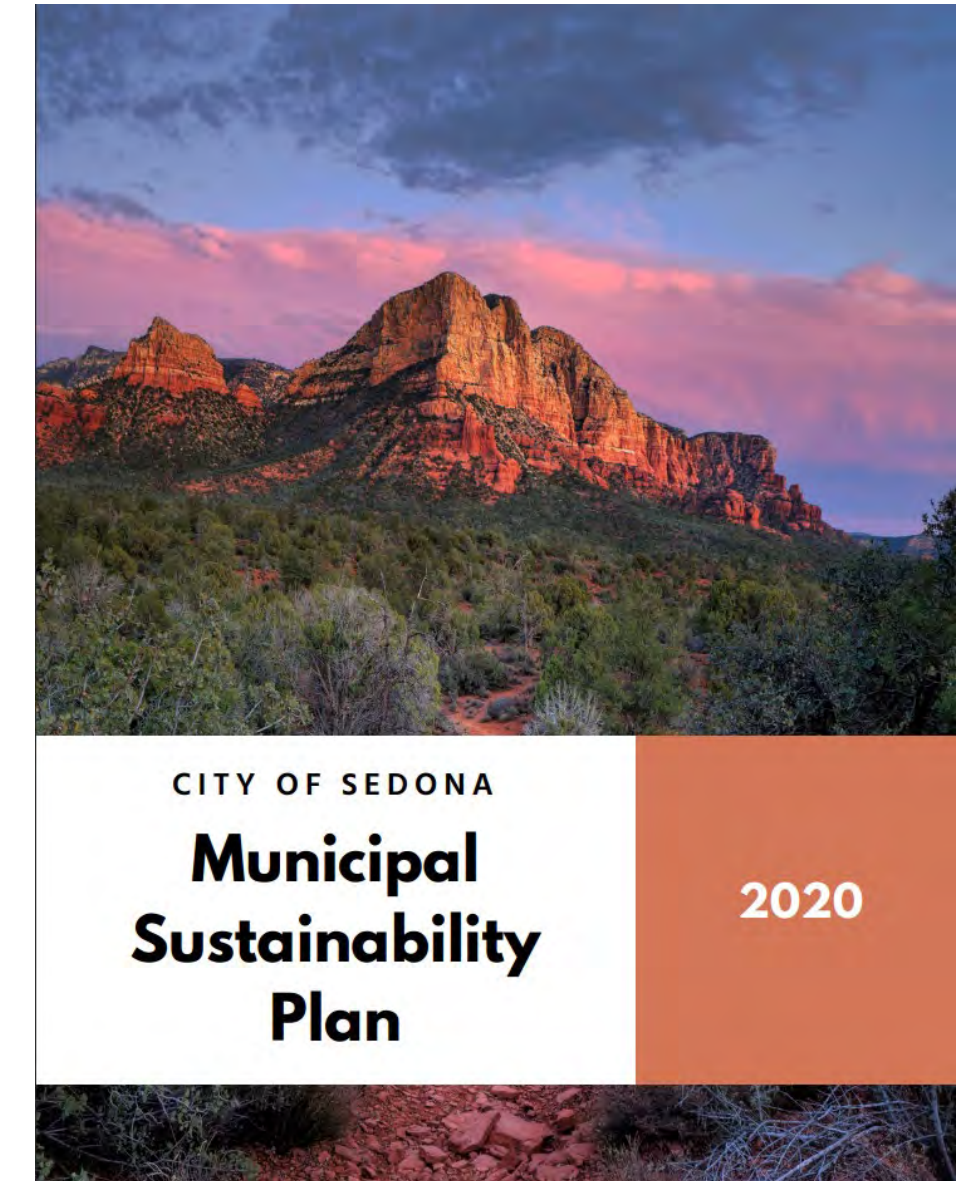
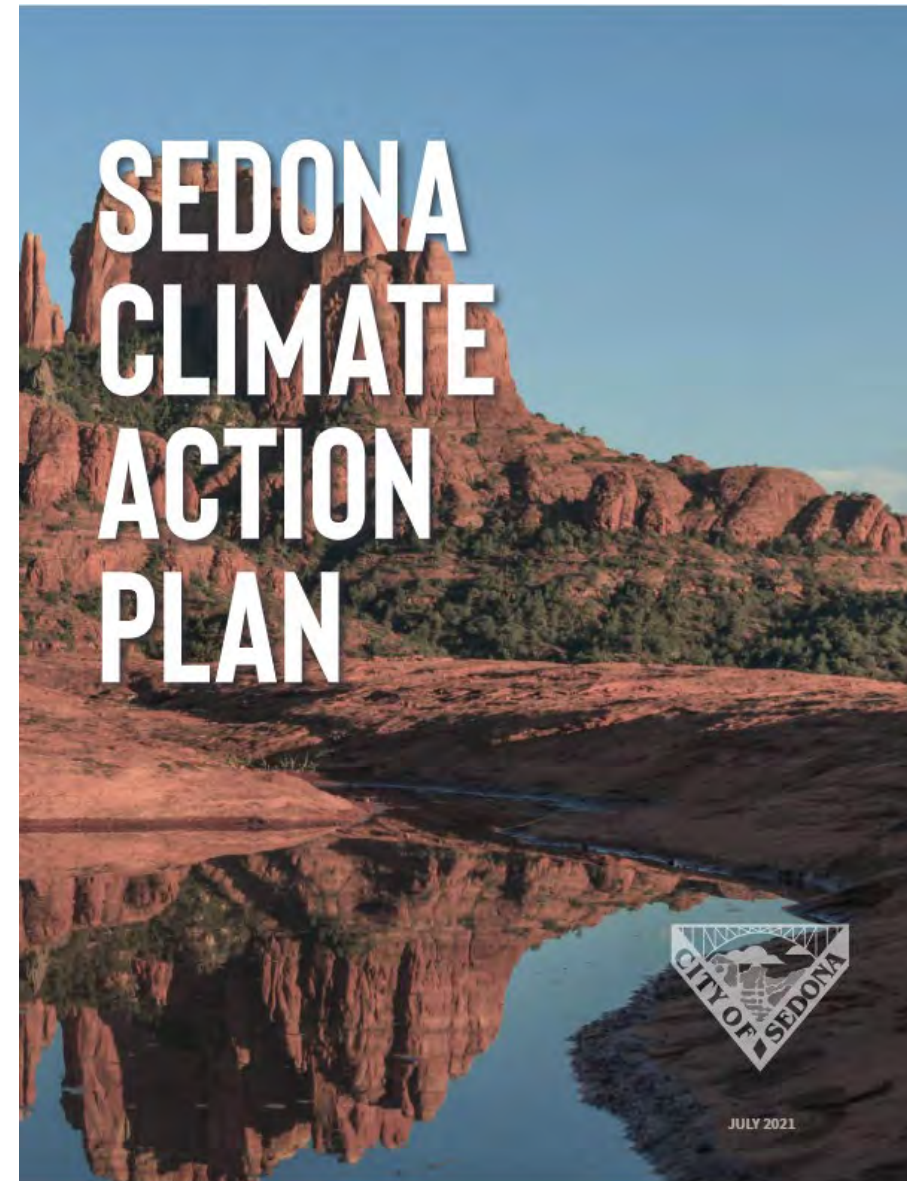

# GHG Inventories and Energy Efficiency Projects Inventories and Audits

- ❑ Municipal and Community Carbon Accounting Conducted Yearly
- ❑ 2022 ASU Industrial Assessment Center Audit
- ❑ Projects Derived from Carbon Accounting Efforts and Audit
  - Solar Lighting at Posse Grounds
  - Green Power Partners with APS
  - EV Chargers at Posse Grounds Park and Sunset Park
  - Home Energy Retrofit Project
  - Anticipated FY24 Streetlights Retrofit Project
  - HVAC Upgrades at Wastewater and Control Systems at Brewer Offices in FY23





# 2022 Municipal Emissions Estimates: 2,050 MT CO<sub>2</sub>e

- **Scope 1** – Direct emissions from owned or controlled assets
- **Scope 2** – Indirect emissions from purchased electricity
- **Scope 3** – Results activities not owned or controlled, but organization indirectly impacts in its value chain

2022 Municipal Emissions Distribution

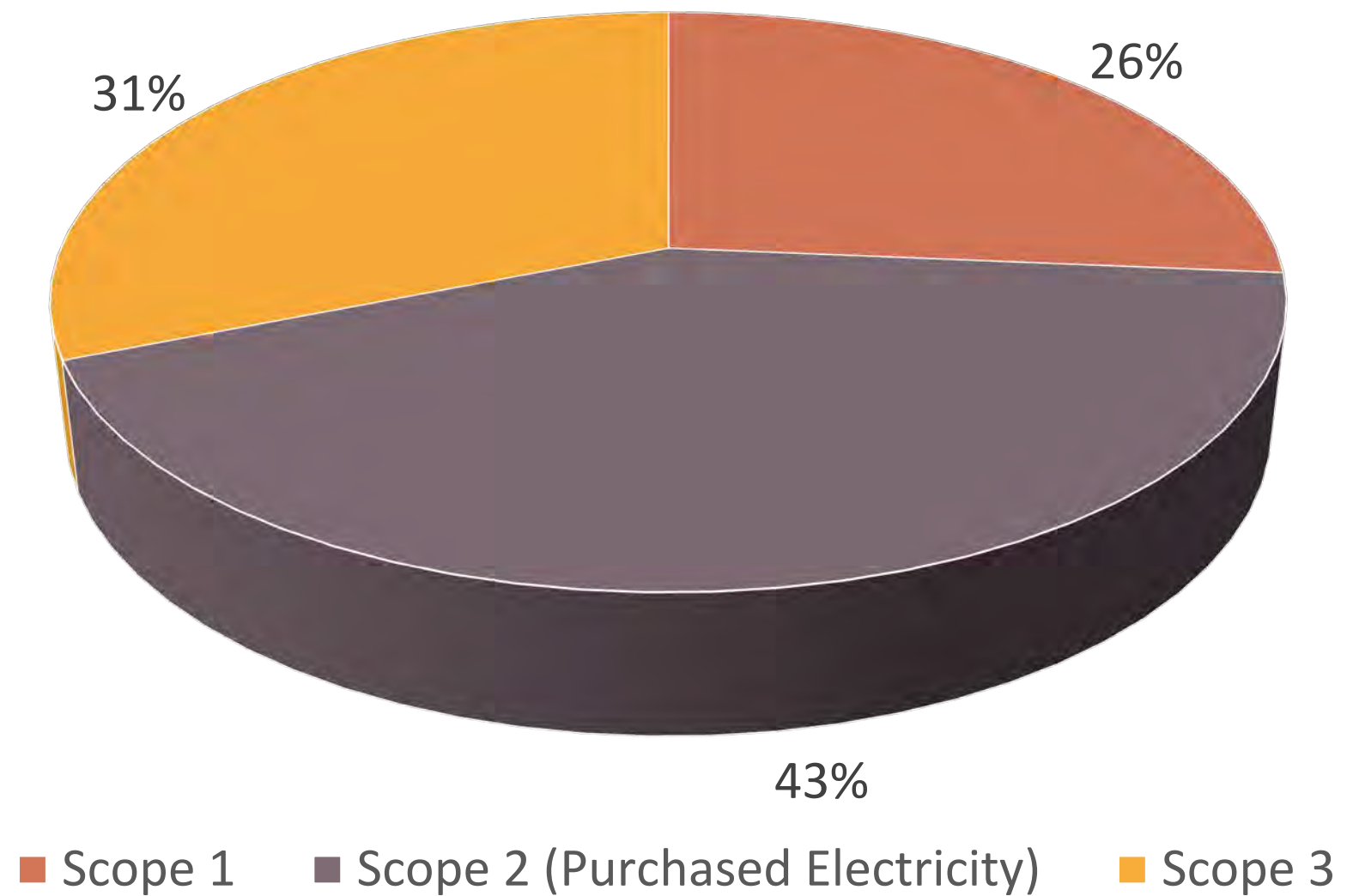

# Decarbonization Needs, Benefits & Goals

## ❑ Needs:

- Roadmap for Long-term Planning
- EV Infrastructure and Transition Analysis
- Electrification of Natural Gas Systems Analysis
- On-site Renewables and Battery Storage Feasibility
- Built Infrastructure Capacity Analysis
- Identify Funding Pathways including IRA Opportunities

## ❑ Additional Benefits:

- Help Inform Municipal and Community GHG Efforts
- Provide Overview of Financial Needs and Project Pathways
- Reduce Environmental Impacts from Municipal Operations
- Lead by Example

## ❑ Goals within Proposal:

- Decarbonization Strategy for GHG Emission Scopes 1 and 2
- Benefit/Cost Analysis
- Capital Planning and Finance

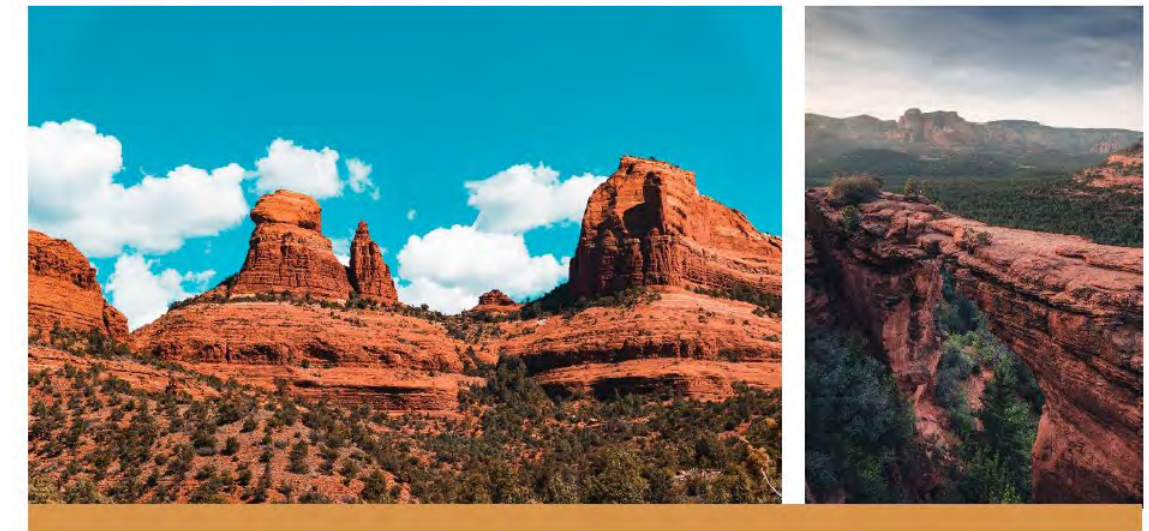

# Budget and Procurement

- CIP Budgeted for Decarbonization Roadmap in FY24
- McKinstry Proposal is \$133,400
- Procurement Utilizing the City of Tucson SAVE Purchasing Cooperative for Energy Management and Consulting Services

PHASE	FEE	NOTES
<b>Decarbonization Roadmap</b>	<b>\$107,400</b>	<b>Includes all scope except for the line items listed below.</b>
<b>Wastewater Treatment Plant Process Energy Evaluation</b>	<b>\$21,800</b>	
<b>Lift Stations and Parks</b>	<b>\$4,200</b>	<b>Includes adding to the roadmap the wastewater lift stations, Posse Grounds Park, Sunset Park, and the historical park on Jordan Road.</b>
<b>TOTAL</b>	<b>\$133,400</b>	

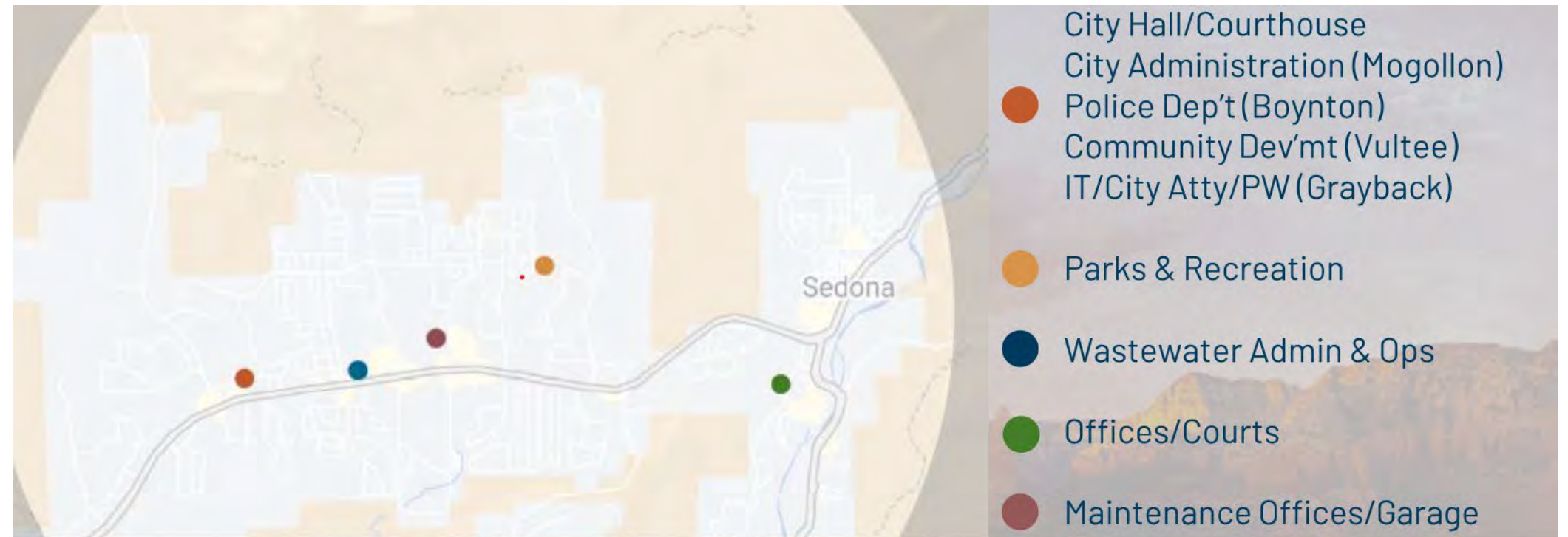

# McKinstry Overview

---



# McKinstry Sedona Decarbonization Team



**Kreischer Davis, PE**  
Team Lead +  
Sedona Liaison



**Mike Gross, PE**  
Technical Director



**Ryan Thomas**  
Energy Engineer



**Brad Liljequist**  
Zero Carbon  
Innovation + Leadership



# About McKinstry

National leader in designing, constructing, operating and maintaining high-performing buildings.

- Founded in 1960
- Headquarters – Seattle WA
- Privately held
- 2,200 employees
- 26 US offices, coast to coast: including Phoenix, Reno, Golden CO, SLC, Missoula, Bozeman

Creating a continuum of expertise and assistance that you can access at **any point in the life of your building.**

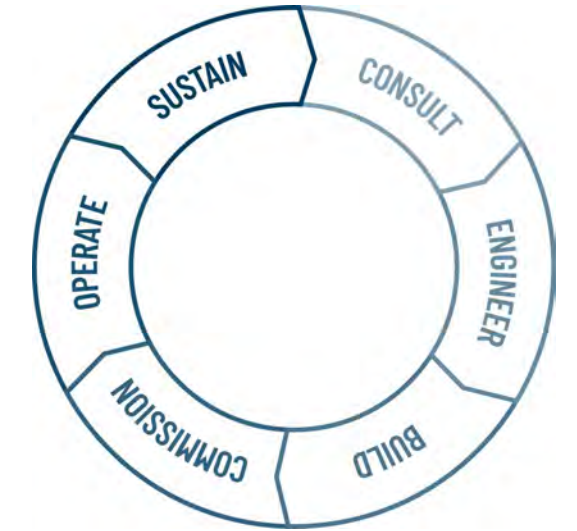

## Our Values



Put people first



Build trusted partnerships



Make a positive difference



Be constantly curious

## Our 2025 Strategy



FACING THE CLIMATE THREAT



DELIVERING AFFORDABILITY



TACKLING SYSTEMATIC INEQUITY

# Some cities we serve...



# Phoenix Office – Local Experience



**2012**  
Office Established

**20**  
Experienced Energy  
Experts



“ McKinstry has a Phoenix-based project team that **fully engaged with the Town's personnel across various department associated with the development and execution of projects.**

Communication has been consistent and flows openly between our main points of contacts.

—Sheila Deschaaf, Deputy Town Manager, Town of Payson.





# Catalyst: Building the Zero Carbon Change We Want to See



# ZERO+ PLANNING

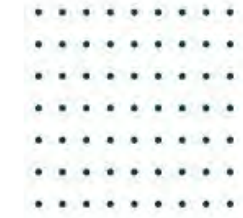

## DECARBONIZATION PREDESIGN

### NEW CONSTRUCTION

If you're building new or repositioning an asset, ZERO+ PLANNING provides **predesign** engineering and analysis services. We help **owners, architects, and developers** select building systems and design measures that maximize long-term asset value and meet enduring sustainability goals.



## DECARBONIZATION ROADMAPPING

### EXISTING BUILDINGS

If you're an **owner or property manager** of an existing building or campus, ZERO+ PLANNING provides you with a detailed, **actionable year-by-year roadmap**. Decarbonization projects are integrated with your master planning, capital budgeting, and sustainability goals.



## DISTRICT DECARBONIZATION

### DISTRICT ENERGY

If you own or are developing a central utility plant, campus energy system, or shared thermal district, ZERO+ PLANNING **drives system selection**. We define upfront and long-term costs, carbon impacts, operational considerations, and phasing plans.

### learn more

ZERO+ PLANNING is delivered with an eye toward future policy, technologies and trends to ensure decarbonization projects are durable and cost-effective for the life of your building. Learn more about each Zero+ service on the following pages:

- Decarbonization Pre-design (for new construction)
- Decarbonization Roadmapping (for existing buildings)
- District Decarbonization (for central utility plants and thermal districts)



# ZERO+ PLANNING

## EXISTING BUILDINGS

For existing buildings, ZERO+ PLANNING creates a year-by-year roadmap of retrofit projects to enable your decarbonized future. Instead of business-as-usual equipment replacements, we evaluate low-carbon end-of-life system upgrades to not only meet operational and occupant needs, but also to reach your decarbonization targets. Whether its adding cooling, building performance standards, energy codes, shareholders, or students driving your goals, we illustrate the costs and benefits of engineered solutions required to reach them.

Importantly, we understand that planning must lead to action - we leverage our construction team, conditioned with millions of dollars of estimates every year, to provide market-ready cost estimating and procurement input to enable long-term planning to translate into near-term action.

### SERVICES INCLUDE:

- Utility data and carbon analysis
- Energy and carbon by end-use analysis
- Facility condition assessments and site audits
- Electrical and structural capacity analysis
- Load reduction, efficiency, electrification, low-carbon fuels, kitchen, and other measure ideation
- Measure scoping, cost estimating, energy, carbon, & equity analysis
- Equipment end-of-life and cooling requirements definition
- Business-as-usual costs and savings
- Decarbonization roadmap
- Stakeholder engagement



Projects beyond 2030 get developed at a minimal level of detail, acknowledging likely technology changes



The roadmap shows the year-by-year prioritization of carbon reduction projects across multiple buildings and disciplines.



Near-term projects get developed to a greater level of detail enabling immediate action.



### FOSSIL FUEL CARBON EMISSION BY END-USE

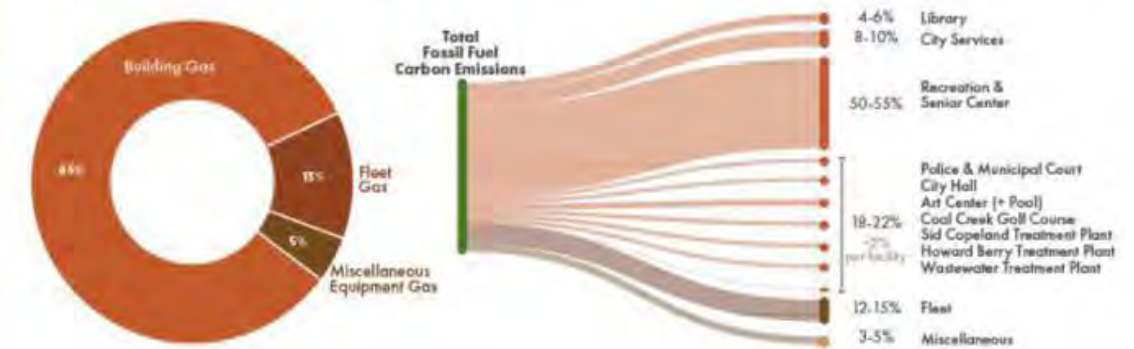

Understanding emissions sources is key to decreasing them.

OUTCOMES, COSTS, & BENEFITS BY MEASURE BUNDLE	BUNDLE 1	BUNDLE 2	BUNDLE 3	BUNDLE 4
	\$AM FIRST COST	INVESTMENT CRITERIA	HIT EUI TARGET	DECARBONIZATION
<b>FIRST COST</b>	\$3.9-4.1m	\$2.8-3.1m	\$10.2-10.4m	\$22.7-23.1m
<b>RESULTING EUI</b> Total Energy Use Intensity after implementation of each bundle and how it compares to the target.	10-11	10-11	10-11	10-11
<b>CARBON SAVINGS</b> Operational carbon impact of each bundle.	90-92% Carbon Reduction	3-5% Carbon Reduction	91-93% Carbon Reduction	93-95% Carbon Reduction
<b>LIKELY TO COMPLY?</b> Likely compliance with WA and Seattle standards.	Yes	Yes	Yes	Yes

Different bundles of measures achieve different outcomes, helping define cost or emissions breakpoints.

### DECARBONIZATION ROADMAP



The decarbonization roadmap shows the year-by-year projects to be implemented with baseline and incremental costs articulated.

# Sedona Decarbonization Target

“...cut Sedona’s greenhouse gas emissions by 50% by 2030...”

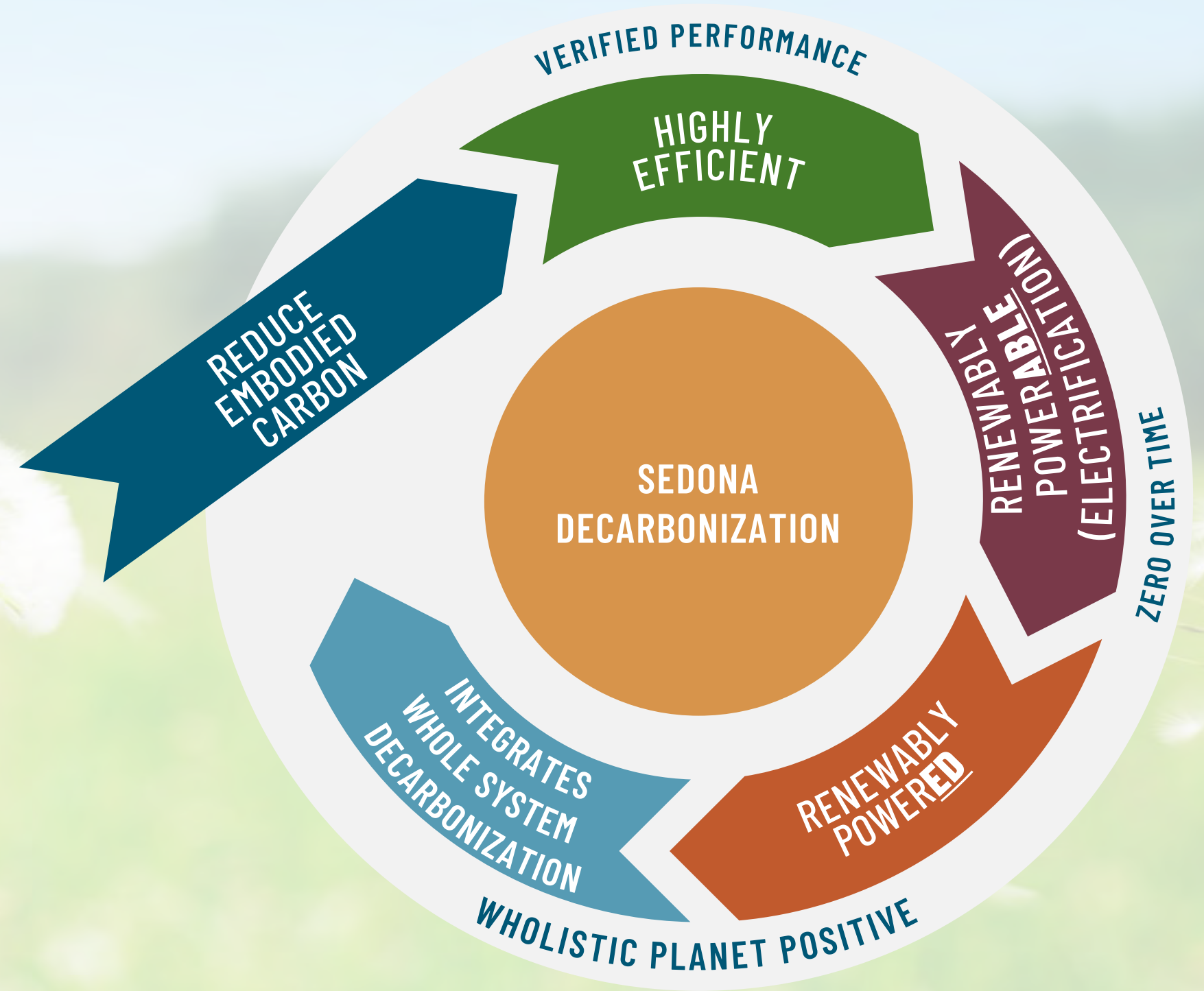

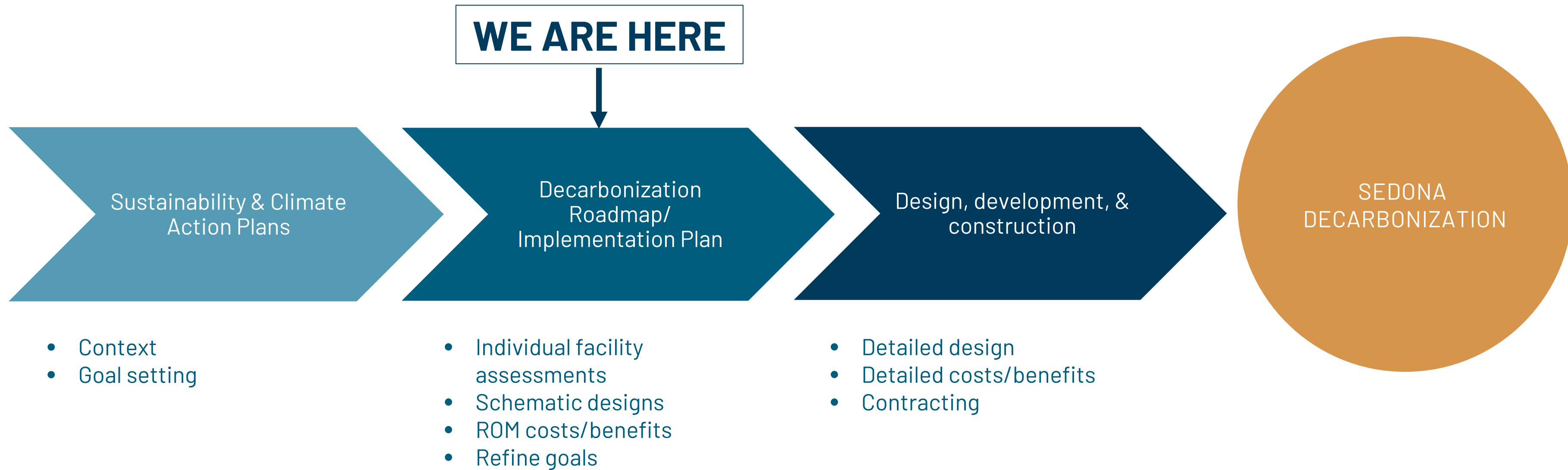

# Decarbonizing Sedona

# Sample existing energy use diagram

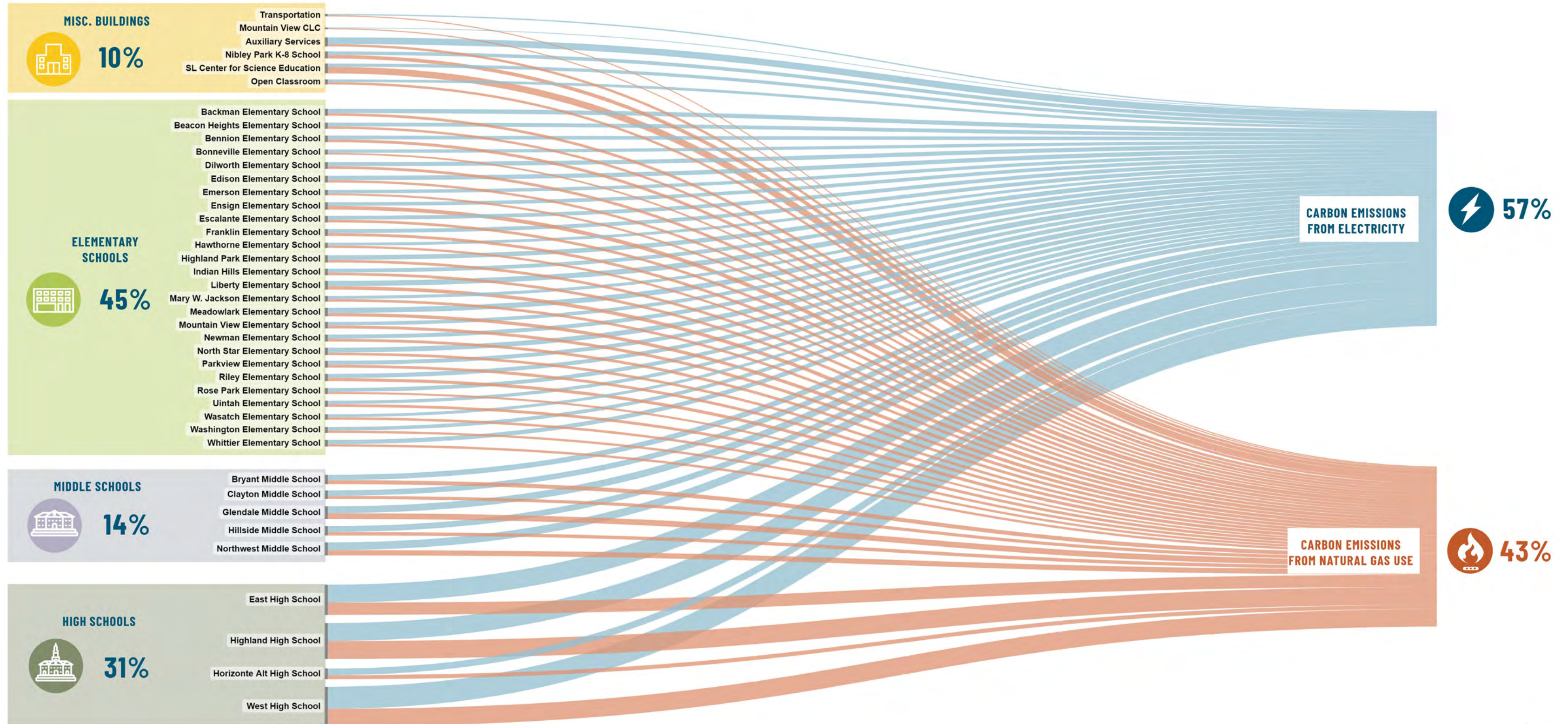

# The big picture – sample diagram

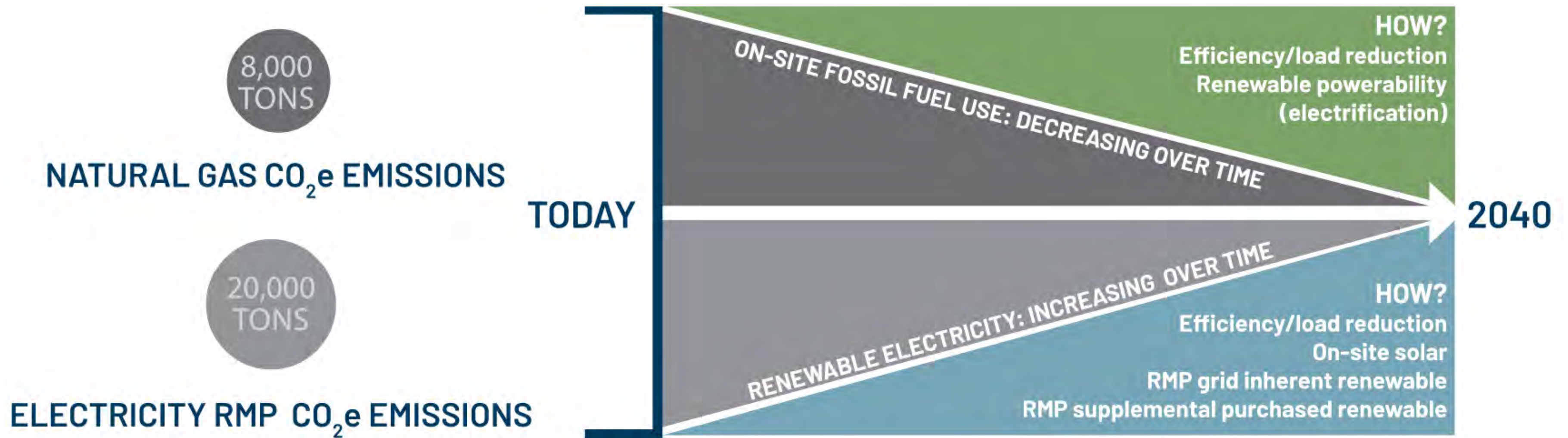

## Fossil Fuel Emissions

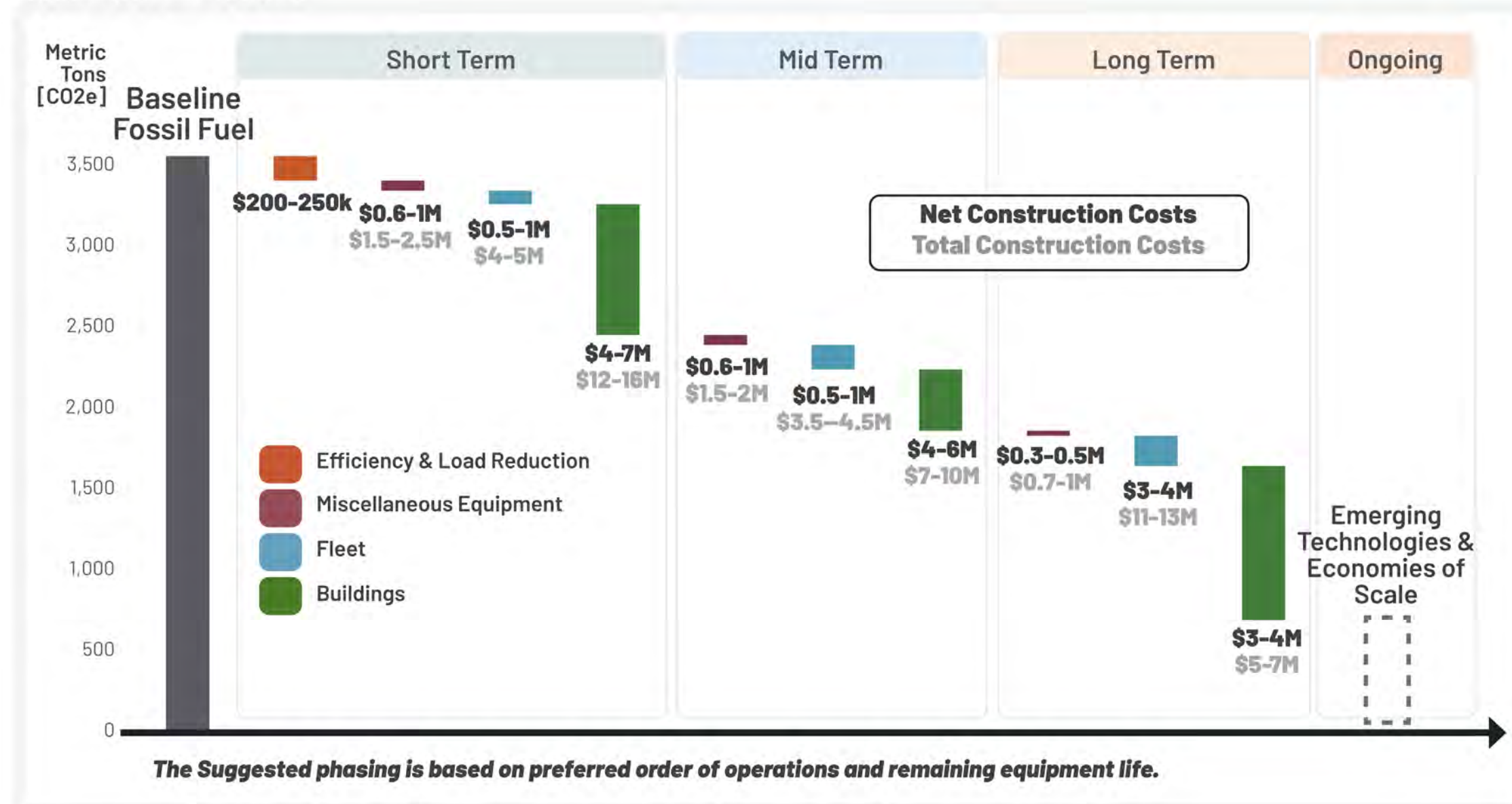

## Electricity Emissions

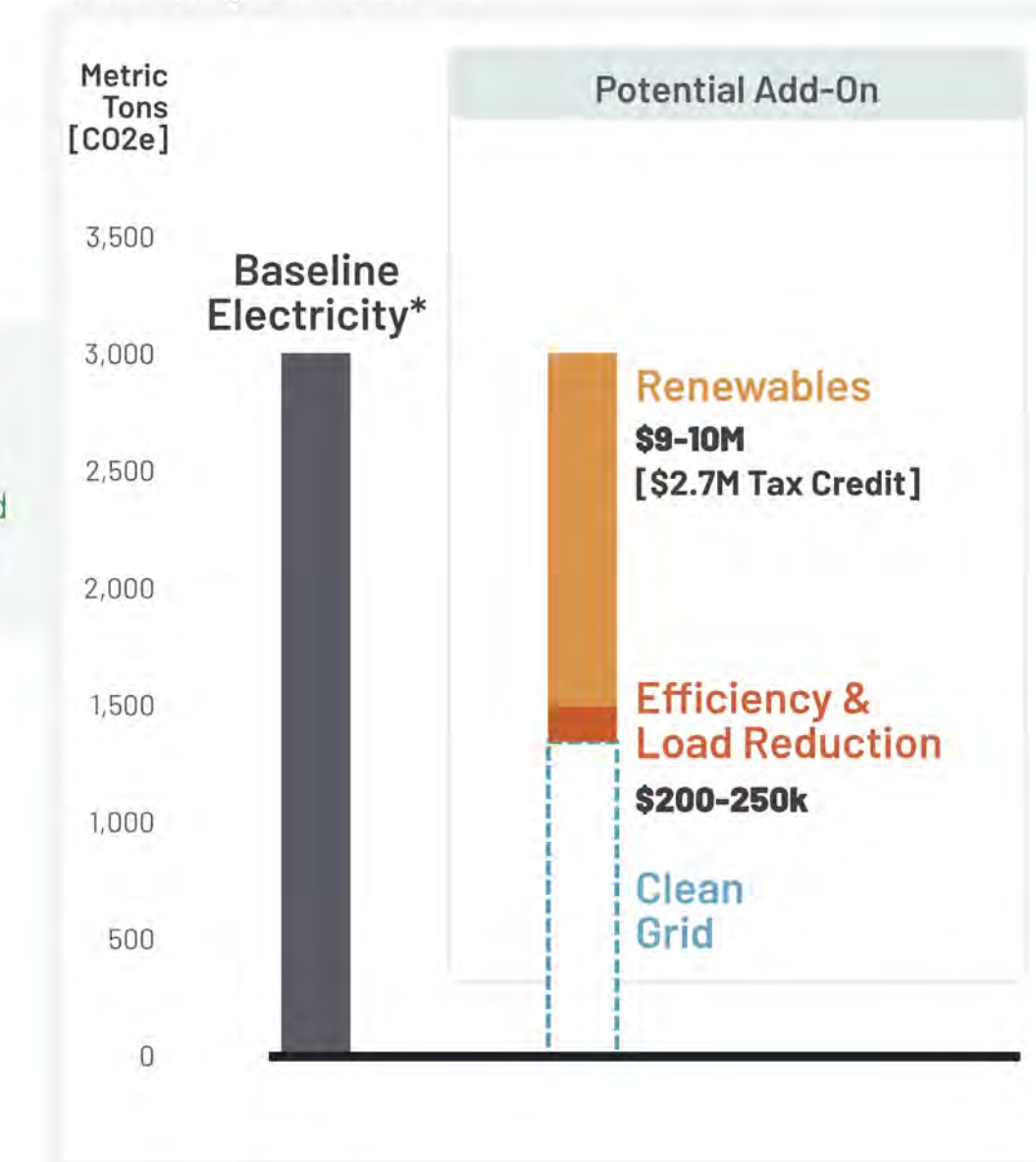



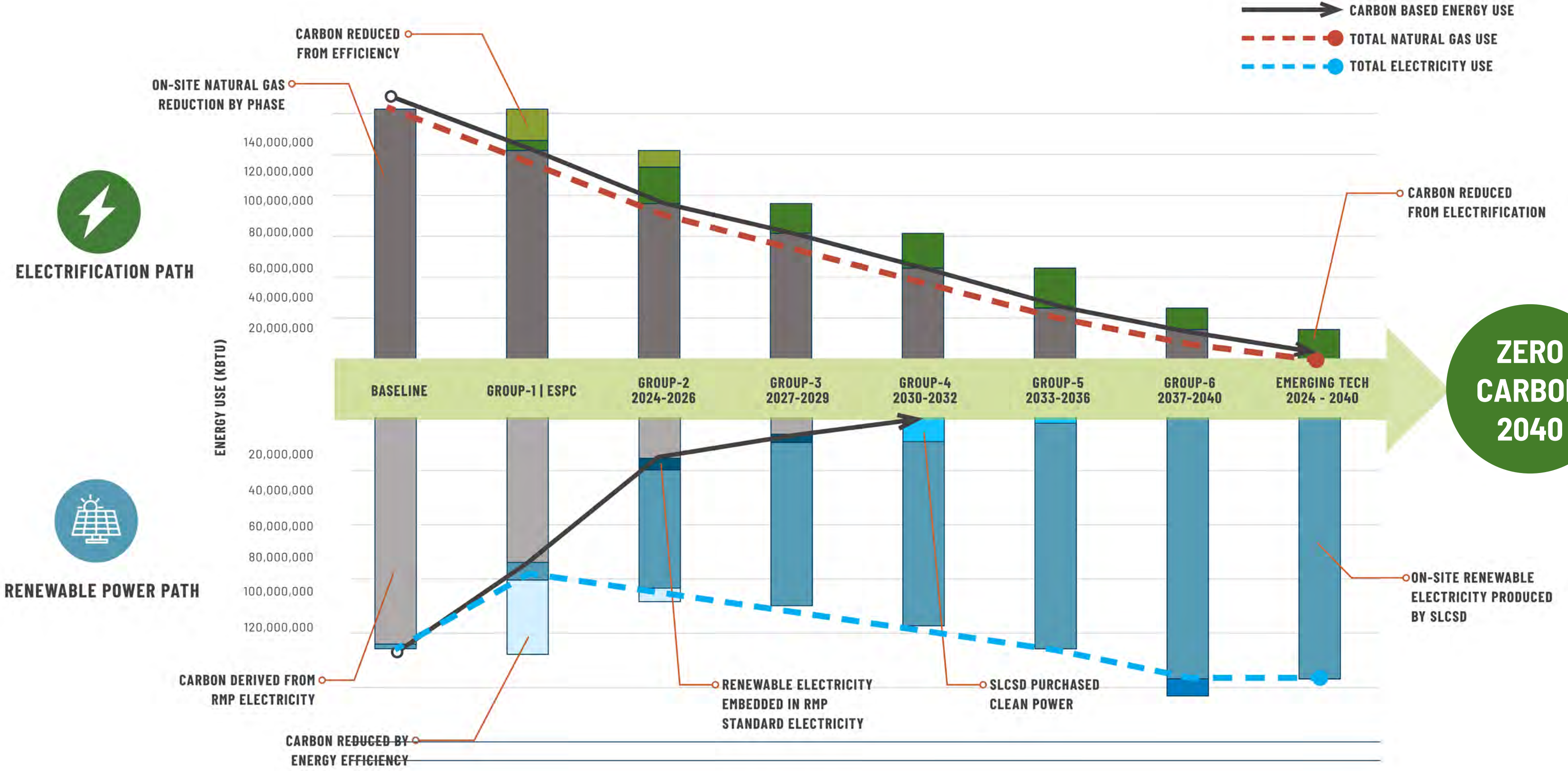

# Rocky Mountain Urban School District – Path to Zero

# Decarbonization and Implementation Plan

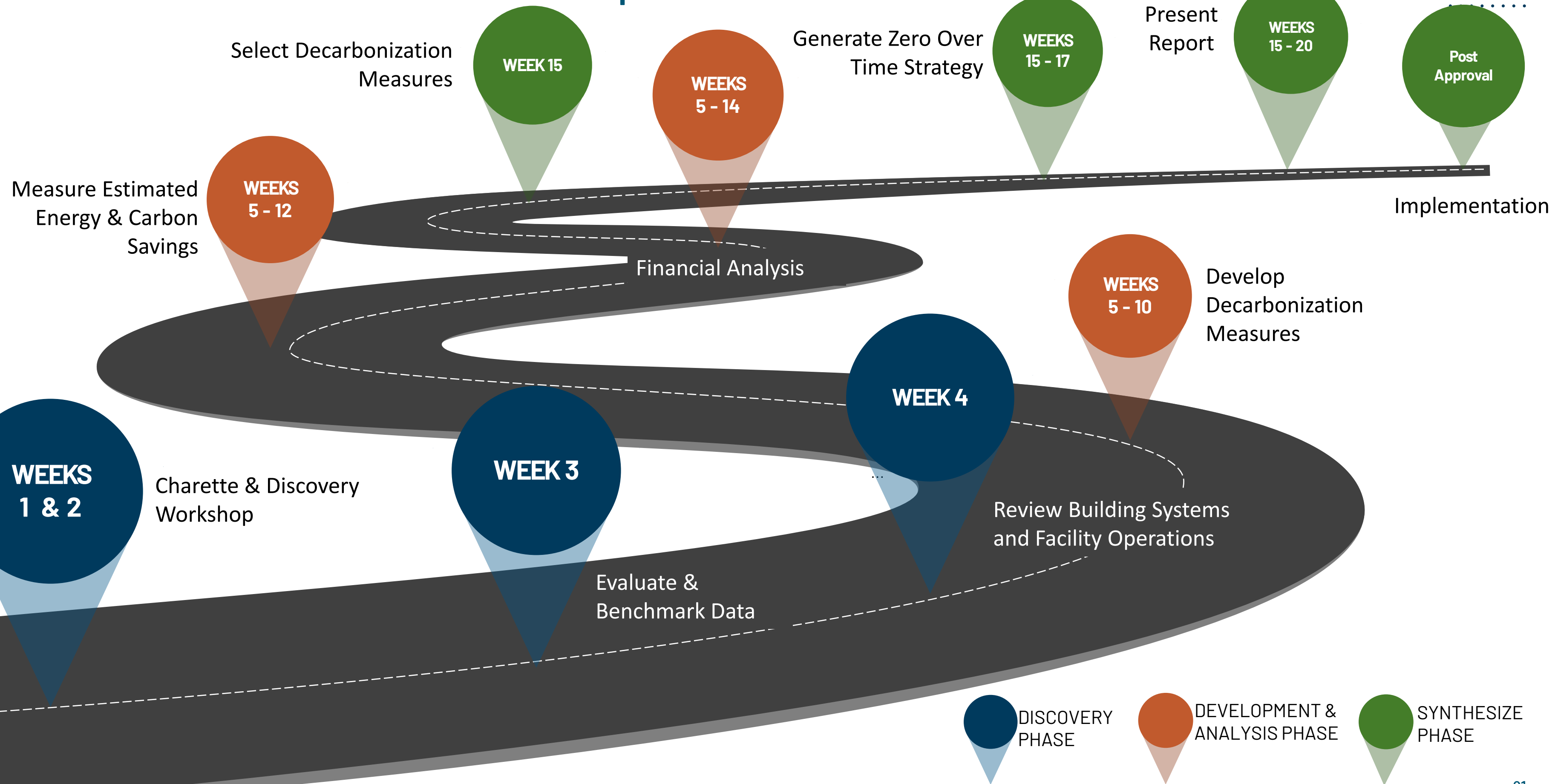

# Thank You

---



# Ranger Station Park Updates & Playground Contract Approval

---

Joshua Frewin, Parks and Recreation Manager

Sandy Phillips, P.E., Asst. Public Works Director/Asst. City Engineer

Larry Farhat, Facilities Maintenance Supervisor





## Current Progress

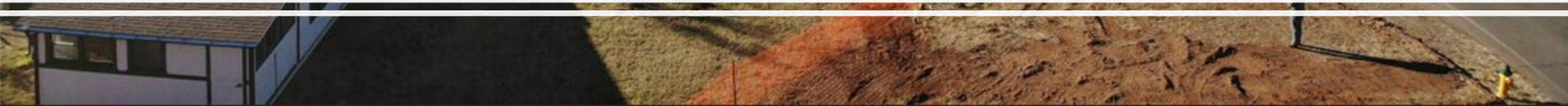



# Site Overview



# Ranger Station Playground

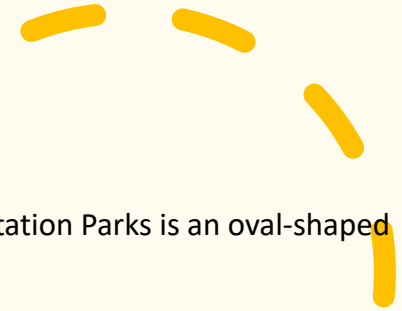

- The dedicated area for the playground portion of the Ranger Station Parks is an oval-shaped area approximately 55 feet wide and 70 feet long.
- Our aim was to design play structures that were natural and one-of-a-kind with a historic feel to blend in with the landscape of the Ranger Station Park.
- Sedona Parks & Recreation is working with Kompan & PlaySpace Design to create a playground that will engage kids in activities that develop body, mind, and friendship while immersing them in nature-based play.
- These Robinia Wood features are beautiful structures creatively designed and loaded with play opportunities created to represent the historical significance of the Sedona Ranger Station.
- Robinia Wood is perfect for play structures as it is highly durable, doesn't get hot, resistant to moisture and bugs, and has absolutely no chemicals or additives.
  - This type of wood is perfect for creating unique and durable beautiful natural playground equipment.
- Users of the playground will be able to admire and be immersed in the history of the beautiful Ranger Station Park while playing on a one of a kind playground experience only found in Sedona.

## The wood we use



### A playful tree sort

The Robinia tree is crooked and whimsical in its look. The tree's bark has deep lines that make it look old and wise.



### Sustainable forestry

Robinia grows faster than any other tree sort and is harvested from sustainable forestry in Europe.



### Robinia lumber

Underneath the bark, the Robinia lumber has a beautiful, warm color. It is soft for children to touch.



### Naturally durable

Robinia wood is nature's most durable wood type. It is known for its natural preservatives that make it ideal for a long lifetime in the outdoors.



### Design on nature's terms

All Robinia play structures are pre-assembled at the factory to fit the naturally uneven wood pieces together.



### Play close to nature

The Robinia wood blends in perfectly with natural surroundings.





# Creativity Through Play

- The Ranger Jeep 4X4 is geared for children 2 - 5 years of age.
- Geared to capture a child's imagination with a gear shift, steering wheel, and various climb and crawl features



# Cocowave Rope Pendulum Swing



Unique fun and engaging swing for all ages promoting balance, teamwork, and coordination on a coconut square rope!

# Cocowave Rope Pendulum Swing



# CocoWave Rope Swing

NRO915



## Cocowave swing

**Physical:** supports muscle strength, sense of balance and space. Bone density is built up when children swing and jump on-off.

**Social-Emotional:** height and speed of swinging supports self-esteem. When listening and negotiating, children develop their empathy and cooperation skills.

**Cognitive:** height and speed of swinging helps children to judge distances and heights.



## Connectors in the side of the rope

**Physical:** allow for foot position between connectors resulting in ease of use when standing up swinging. Develops muscle strength.

**Social-Emotional:** room for different body positions like standing, sitting and lying.



## Coconut rope

**Physical:** balance and coordination is supported when walking the swaying rope. A good sense of balance transfers to other skills such as sitting still on a chair. Bone density is developed when jumping off.

**Social-Emotional:** children swaying together on the rope experience their own and others' movements. This spurs cooperation and consideration, e.g. when passing others on the rope.

**KOMPANI**  
Let's play



## Chains

**Physical:** space between chains supports a comfortable grip for use of muscle strength when standing up swinging.



# Signature Features

- Marion, South Carolina
- Small town with a population of 6,314 residents
- Created a play feature with a "SWAMP FOX" a signature of Marion, SC.
- Represents General Francis Marion from the Revolutionary War, who was known as the "Swamp Fox".
- A similar structure was also created in Prague, Czech Republic creating something unique and spectacular, with extraordinary play features.





ICONIC FEEL COMMUNITY BRANDING



PARENT JAVALINA SIZE



CUSTOMIZABLE PLAY FEATURES

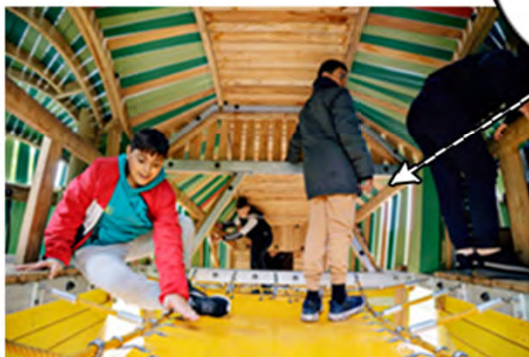

BABY JAVALINA SIZE

KOMPAN! Let's play



# HISTORIC RANGER STATION PARK CONCEPTS

# Mother Javelina



# Baby Javelina





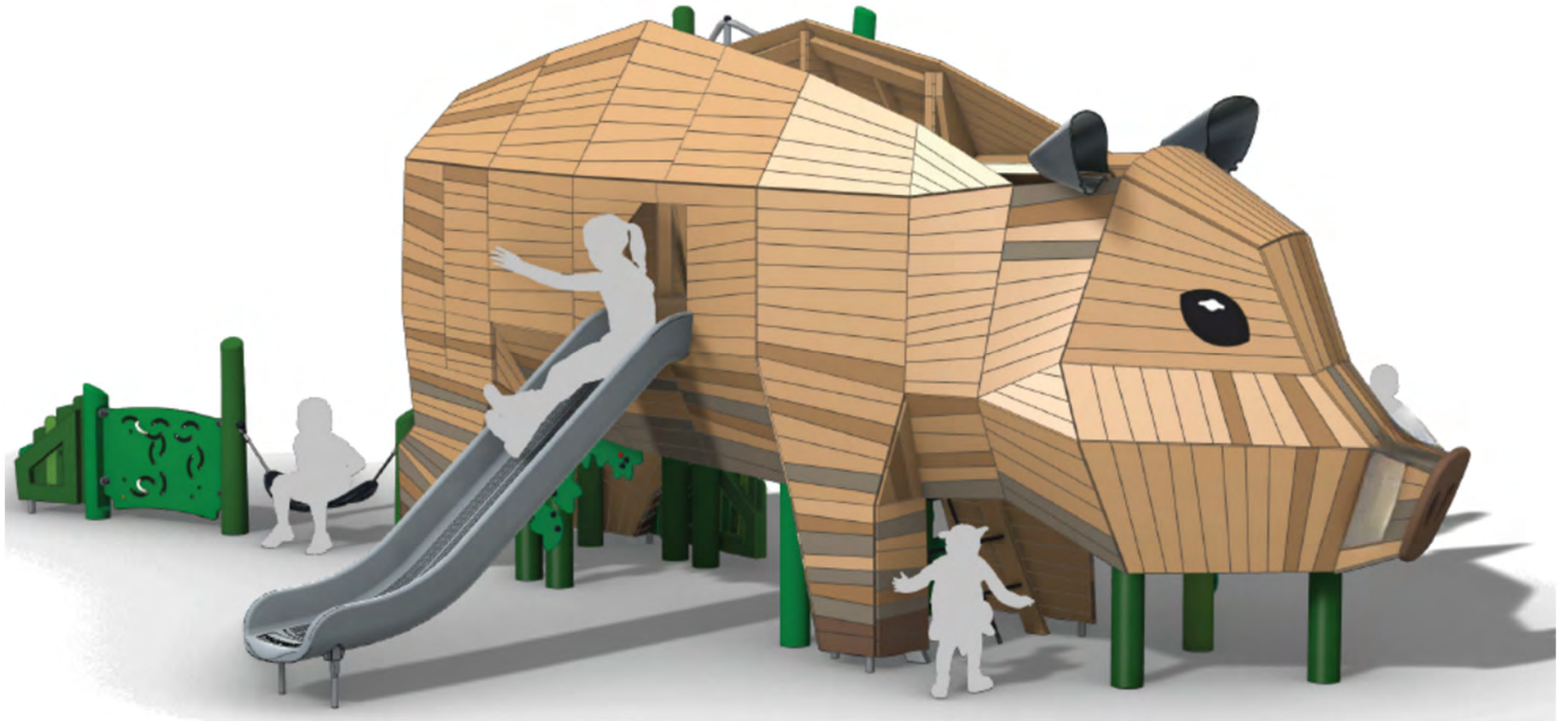

# Activities

- 1. Ring game panel



- 2. Hammock



- 3. Slide



- 4. Climbing net
- 5. ADA net access
- 6. Fireman's pole
- 7. Ladder

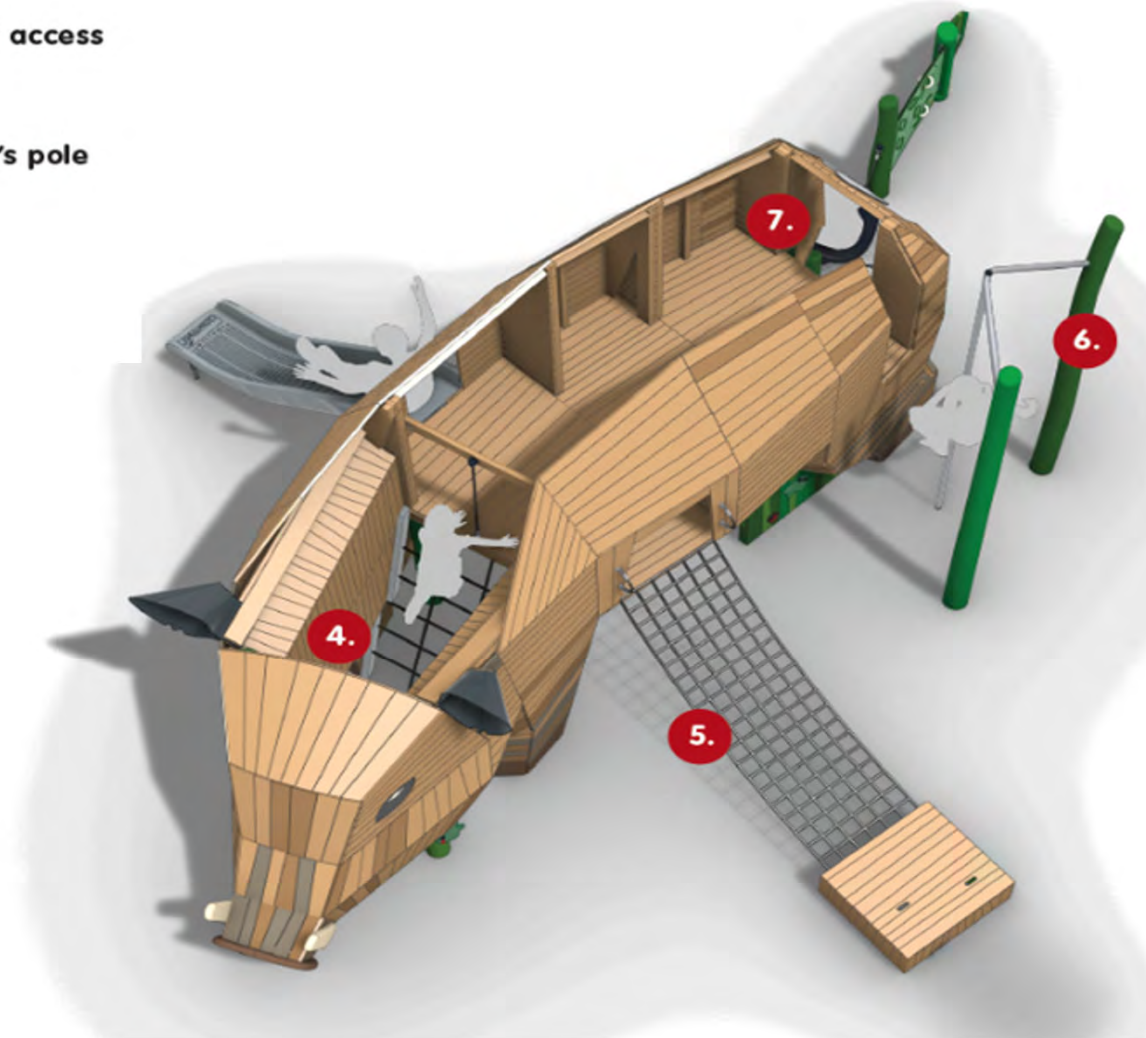

# Main Dimensions

Max. fall height: 150 cm / 4'-11"

Total height: 314 cm / 10'-4"

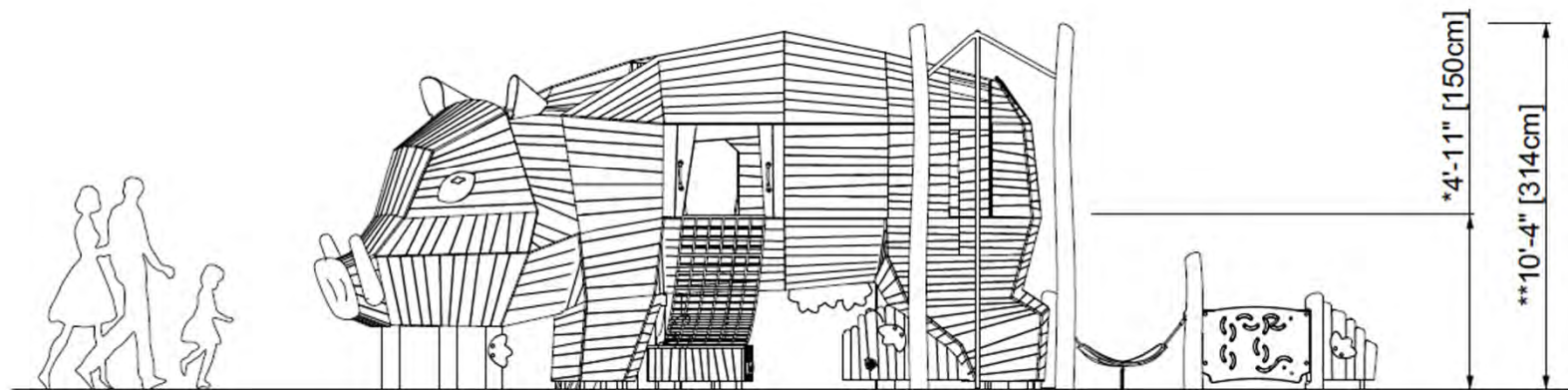

KRS8200848





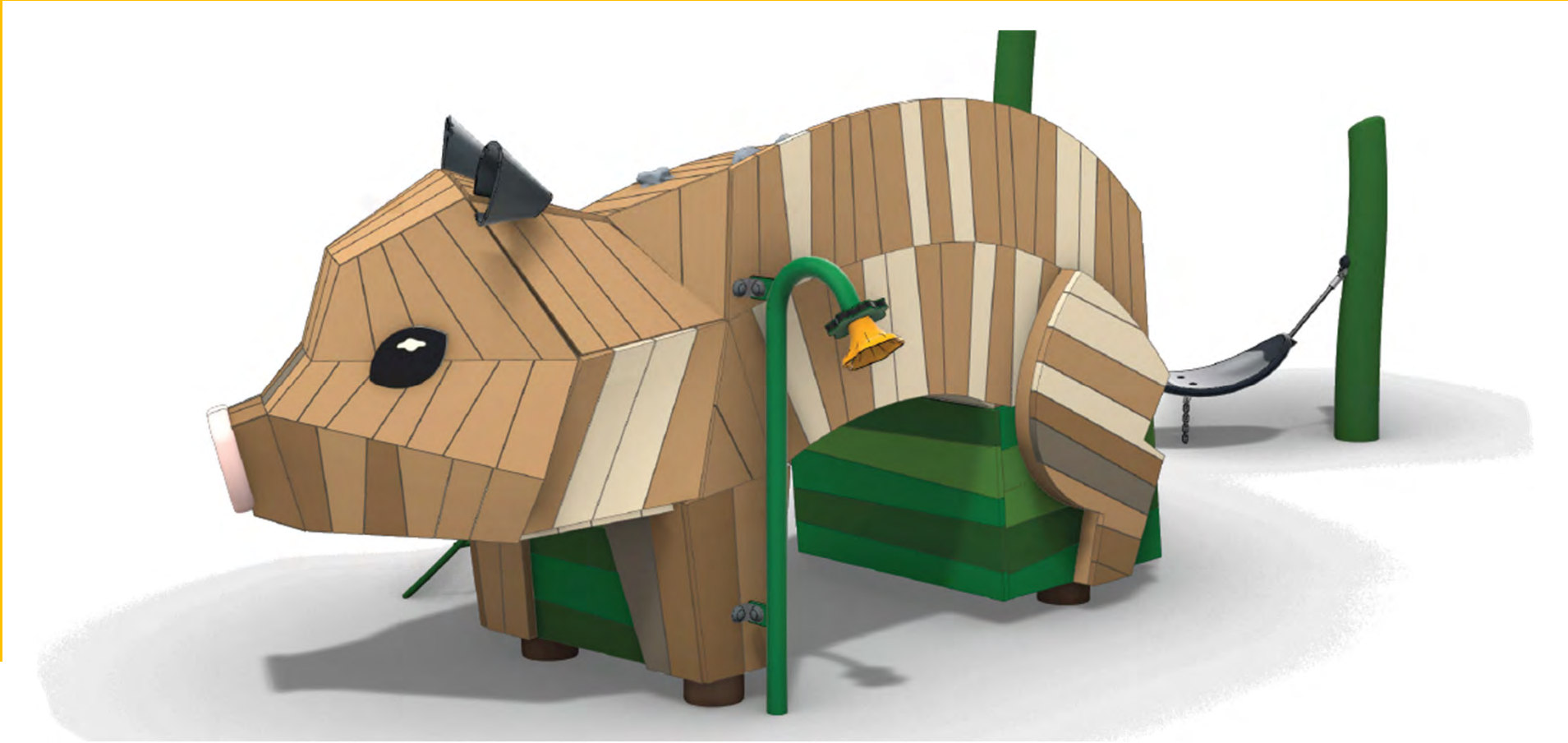

# Activities

- 1. Climber
- 2. Ladder
- 3. Net
- 4. Play panel
- 5. Peepholes
- 6. Hammock
- 7. Talking tubes



# Main Dimensions

Max. fall height: 140 cm / 4'-7"

Total height: 156 cm / 5'-1"

**KOMPAN**  
Let's play

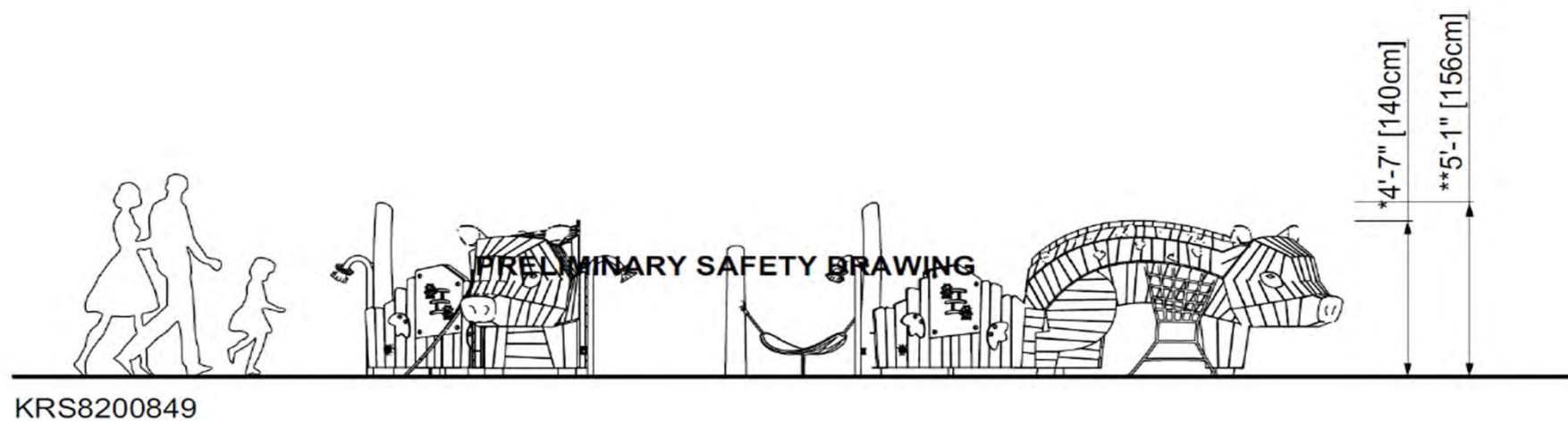



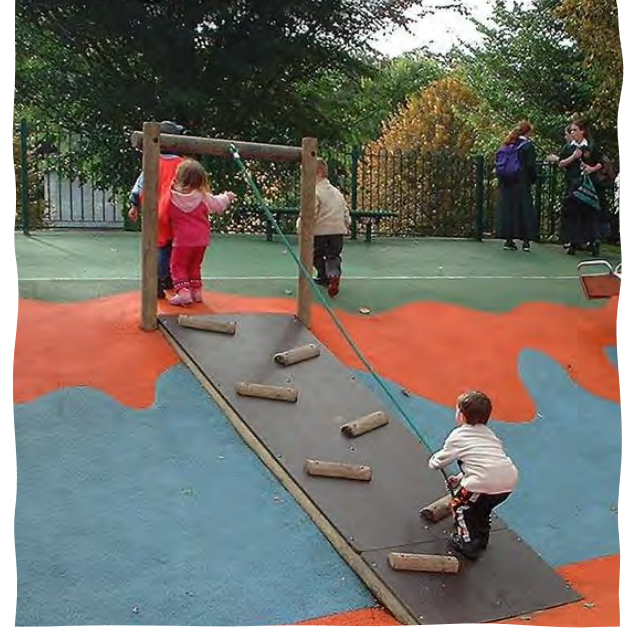

# Natural Embankments

---





Adult Exercise & Play



---

## Ranger Station Playground

---

- TIMEFRAME:
  - If ordered by December 1<sup>st</sup> – all equipment will be built and shipped to arrive by April 1<sup>st</sup>, 2024.
  - Complete installation and rubber surfacing will take 3-4 weeks from time of equipment arrival.
  - With playground and adult fitness equipment grand opening date targeted for May 1<sup>st</sup>, 2024.



# Playground Cost



5698 S Shady Farm Lane  
Murray, Utah 84107  
801-274-0212

Quote Number:  
00003660

Created or Revised Date:  
11/13/2023

Qty	Manufacturer	Product Code	Product Description	Color	Install Type	Unit Price	Discount (Percentage)	Extended Price
1	Kompan	Mama Javalina	Robinia Sculpture Mama Javalina	TBD	In Ground	\$215,000.00	12.00%	\$189,200.00
1	Kompan	Baby Javalina	Robinia Sculpture Baby Javalina	TBD	In Ground	\$70,000.00	12.00%	\$61,600.00
1	Kompan	NRO563	Jungle 4 x 4	TBD	In Ground	\$22,160.00	12.00%	\$19,500.80
1	Kompan	NRO915-1001	CocoWave Rope Swing	Natural	In Ground	\$15,960.00	12.00%	\$14,044.80
2	Kompan	PCM110121-0950	EMBANKMENT SLIDE - GREENLINE - PE SLIDE	Greenline	In Ground	\$7,870.00	12.00%	\$13,851.20
1	Kompan	FRO10200-1001	COMBI 2 ROBINIA	Natural	In Ground	\$8,440.00	12.00%	\$7,427.20
1	Kompan	PSF - K	PS Freight Kompan		Freight	\$21,600.00		\$21,600.00
1	Competitive Edge	Competitive Edge	Installation - Skilled Labor			\$89,465.00		\$89,465.00
1	Competitive Edge	Competitive Edge	Installation - Skilled Labor	TBD - 50/50 PIP Rubber	Varied Thicknesses for varied fall heights. Two colors. Provide and Install	\$57,200.00		\$57,200.00

## NOTES

- Please inventory product within 5 days of receipt and notify us of any problems.
- We are a supplier only. Customer is responsible for accuracy and conformity to plans and specifications.
- Freight has been quoted for single delivery. If customer requires multiple deliveries, additional costs will apply.
- Customer will be prepared to receive material upon delivery, which may include offloading equipment. If unable, customer is responsible for additional storage and/or re-consignment fees.



KOMPAN INC & PlaySpace Designs work as part of the Mohave Co-Op to ensure the purchaser gets the best price possible.

Price includes:

- All Playground Equipment
- All Installation
- Adult Fitness Equipment
- Rubber Playground Safety Surfacing

Grand Total: \$503,763.06

# Ranger Station Playground

---

- GOAL: To create a unique play area at the Ranger Station Park that represents the uses of the landmark buildings, while creating a fully immersive natural play environment that uses the landscape's natural features. Utilize play features that involve the use of imagination, motor skill development, variety, and creativity to engage children in this historical play environment.
- - Features include:
  - Ranger Jeep 4X4 geared towards children 2-5 years old for role-play and motor skill development.
  - Large climbable Javelina mother and a slide off her side great for kids of all ages.
  - Baby Javelina with climbing stones around the body following the mother with play features suited for children under 5.
  - Cocowave Rope Pendulum Swing for fun and teamwork for all ages
  - Rubber Play Safety Surfacing in playground area
  - Embankment slides utilizing cascading water detention basins
  - Adult Fitness Station



Thank you!



# SIM-1B Uptown NB Improvements



## PROJECT STATUS :

- 100% design, additional survey for stairway from SUP to L'Auberge
- Public Outreach Parking Impacts Spring 2023
- Amara RHT Lane
  - Substantially complete
  - AC repairs & final striping

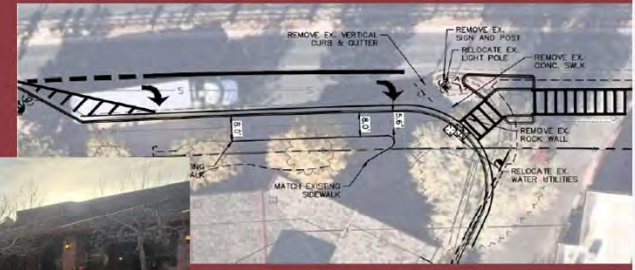
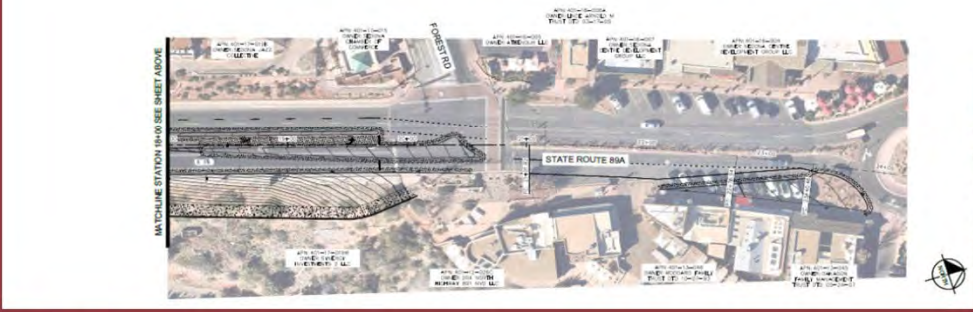

August 8, 2023, SIM Update presentation slide detailing lane extension to the crosswalk



# Uptown Northbound Improvements

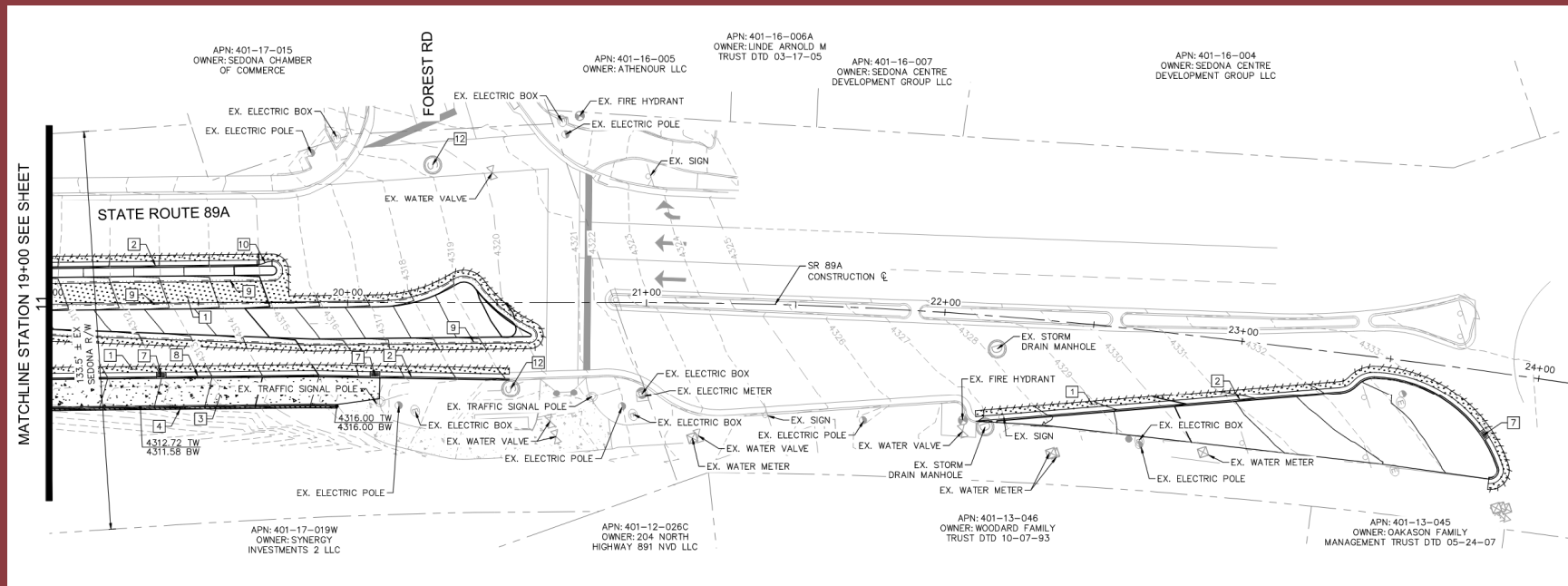

[WWW.SEDONAAZ.GOV/SIM](http://WWW.SEDONAAZ.GOV/SIM)