

July Moment of Art
Arvel Bird

I have invited award winning recording artist, Arvel Bird, whose "Celtic Indian" brand is a reflection of his mixed-blood American Indian and Celtic heritages.

Classically trained as a violinist, Arvel's compositions + performances are a confluence of styles shown by his extraordinary love of diversity, which are revealed in his 25 CD releases. Five of his releases have earned him international music awards.

Arvel attended ASU on a music scholarship and later transferred to the Midwest where he continued his musical education and became a 4-time Indiana State Fiddle Champion.

He has toured with Glen Campbell, Loretta Lynn, Tom T. Hall, Ray Price, Louise Mandrell & Clay Walker, which led him to launch his own successful 19 year solo career. Arvel has toured worldwide from Toronto's Sky Dome, London's Royal Albert Hall and Paladium to Washington DC's & NYC's Smithsonian museum and Florida's Kennedy Space Center.

Arvel will be performing his "Titanic Memorial Concert" at Mary Fisher Saturday, July 20 at 7pm. This will be a soul-stirring evening of music, stories and stunning graphics that take you on a journey aboard the Titanic. It is about seeing the beauty in the tragedy and dealing with our grief about loss, realizing that grief and loss are written into the fabric of life.

The concert is "An act of kindness born from loss which fills us with a strange mix of happy and sad all at once. Sad because of so much loss but happy because we choose to share our gift of remembrance with you." (Lisa Currie/Arvel Bird)

Today he will play Search for Discovery and Distant Shore.

Please welcome Arvel Bird.

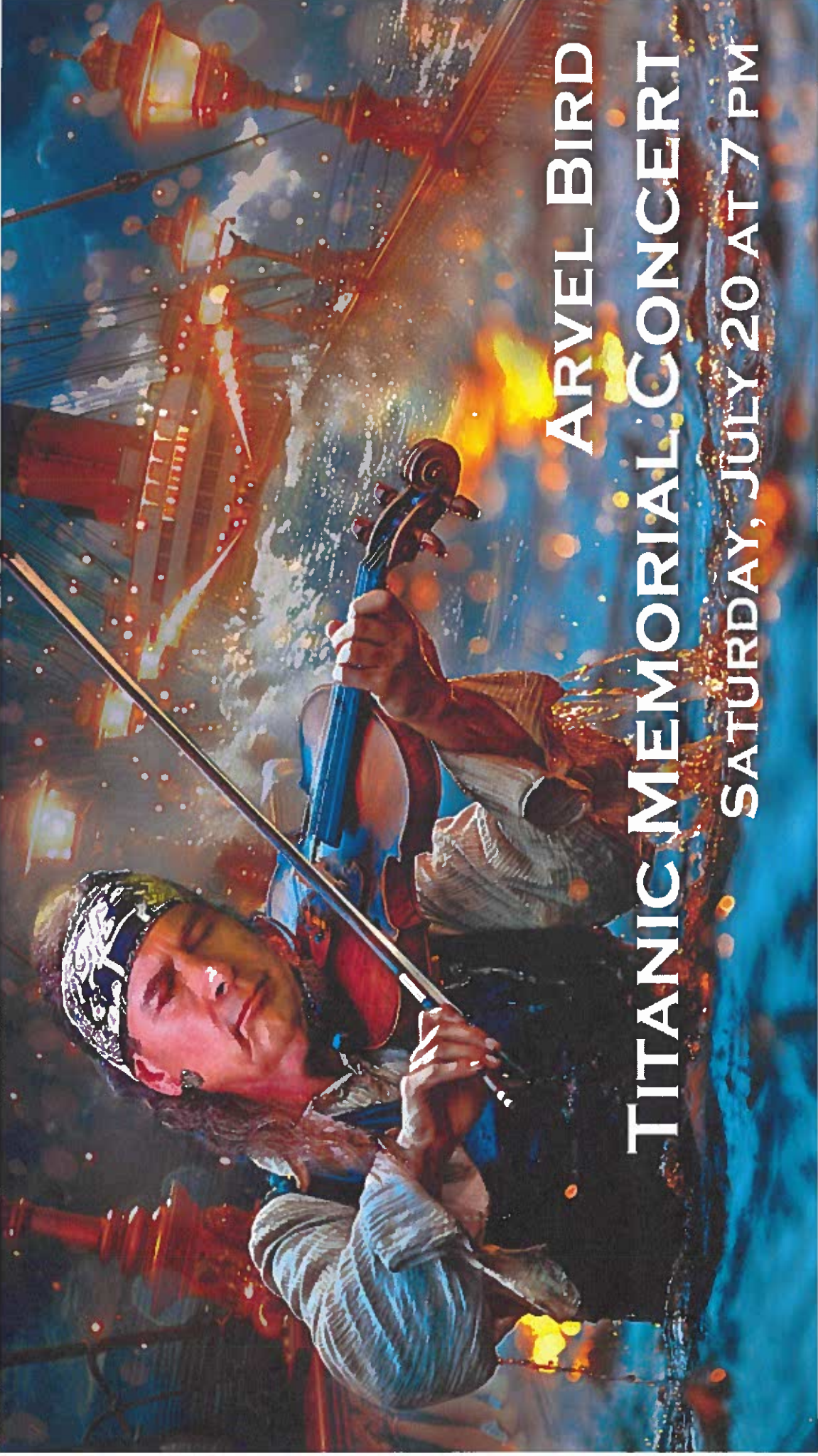

ARVEL BIRD

TITANIC MEMORIAL CONCERT

SATURDAY, JULY 20 AT 7 PM



BCT Sedona Multifamily Workforce Housing

An affordable, multi-family workforce housing
development for the community of Sedona

BCT Sedona Multifamily, LLC

will provide:

- 54 units of multifamily workforce housing
 - 36 apartment units
 - 18 townhome units
- Half of All Units Will Be Designated Affordable
 - 27 units restricted to 120% area median income (AMI) for 10 years
- Short Term Rentals Prohibited
 - No units may be used for short term rentals
 - Term of restriction to be determined

Sedona will permit:

- **Increased Building Height up to:**
 - Building A: 40.5 feet above natural grade (“ANG”)
 - Building B: 41 feet ANG
 - Building C: 42.5 feet ANG
 - Building D: 36.5 feet ANG
 - Building E: 35.5 feet ANG
 - Building F: 37.5 feet ANG
 - Building G: 33 feet ANG
- **Setback Variance:**
 - Minimum front setback reduced by 15%, from 20 feet to 17 feet



Disclaimer: Yavapai County is not responsible for any errors or omissions in this mapping product. Yavapai County assumes no responsibility for errors, omissions, and/or inaccuracies in this mapping product.

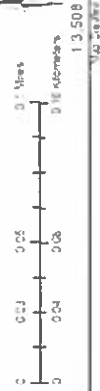

13 508

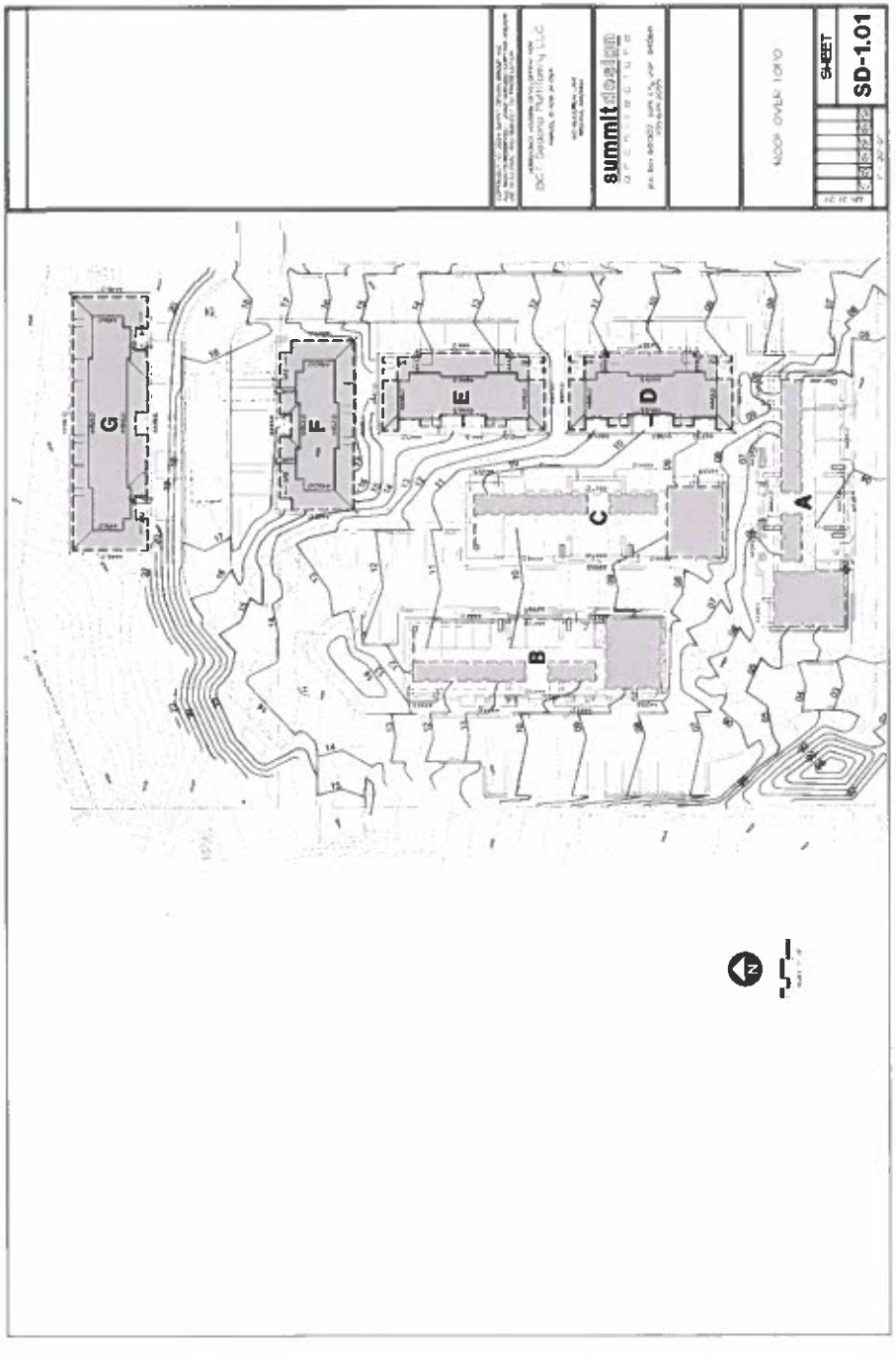





Thank you

BCT Sedona Multifamily, LLC
Aspey Watkins & Diesel, PLLC
(928) 282-5955
120 Soldiers Pass Road
Sedona, AZ 86336